

Corona del Mar
Entry Improvements



CITIZEN ADVISORY PANEL



Agenda

1. Call Meeting to Order
2. Roll Call
3. Approval of Minutes from November 16, 2011
4. Current Business
 - a. Review of Preliminary Design Concepts
 - b. Entry Design Guideline discussion and direction to Staff
5. Public Comments (3 minutes per speaker)
6. Next Meeting – January 25, 2012, 4:00 pm – 5:30 pm
7. Adjournment



Roll Call Approval of Minutes





- Review of Preliminary Design Concepts
- Discussion and Direction to Staff

Mike Sinacori, Assistant City Engineer
Harry Kobzeff, Landscape Architect, TCLA



Project Background



- Neighborhood Revitalization Committee
- One of five CAP's formed by Council action
- Coronadel Mar Entry Improvements
- Gateway / Beautification / Pedestrian
- CAP Purpose – Develop design plan as basis for Capital Improvement Project and make recommendations to CC Ad Hoc Committee
- Anticipate four CAP meetings to complete and prepare design plan and recommendations



Project Background

- Corona del Mar Vision Plan
- Extensive Public Outreach and Consensus
- Community Support
- Significant Business Improvement District (BID) Investment in Improvements
- Current BID Funding Available

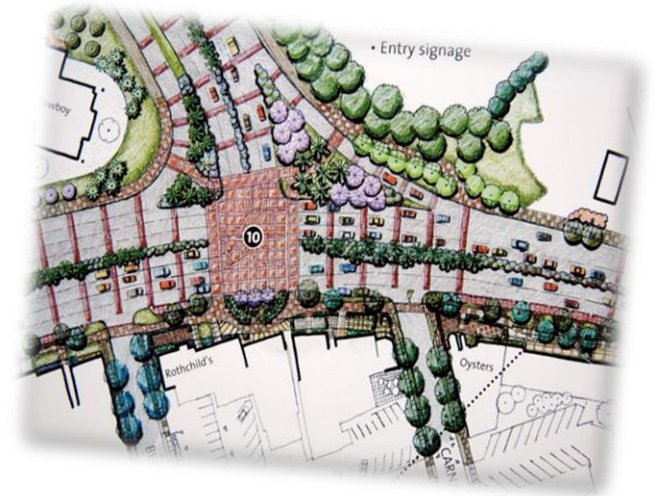



- 9 Corona Del Mar Plaza**
- Additional street trees in accordance with previous sight plane agreements
 - Enhance pedestrian entry

- 10 MacArthur Intersection**
- Enhanced paving
 - Expand medians/enhance landscape in accordance with previous sight plane agreements
 - Realign south curb fronting restaurant row to widen sidewalk
 - Color concrete bands
 - Entry signage

- 12 Dahlia Intersection**
- Enhanced paving
 - Curb tapers to expand curbside landscape
 - Seating

- 8 CDM Village West Gateway at Avocado Intersection**
- Enhanced paving
 - Landscaped medians
 - Curb taper with planter at gas station
 - Entry signage
 - Color concrete bands

- 11 Restaurant Row**
- Create garden-walk with outdoor dining by widening sidewalk
 - Enhanced landscaping along garden walk and at outdoor dining
 - Enhanced garden walk paving
 - Special outdoor lighting for storefronts and outdoor dining

Enhance landscape in front yard



"Restaurant Row" – Begonia and Coast Highway looking East to MacArthur

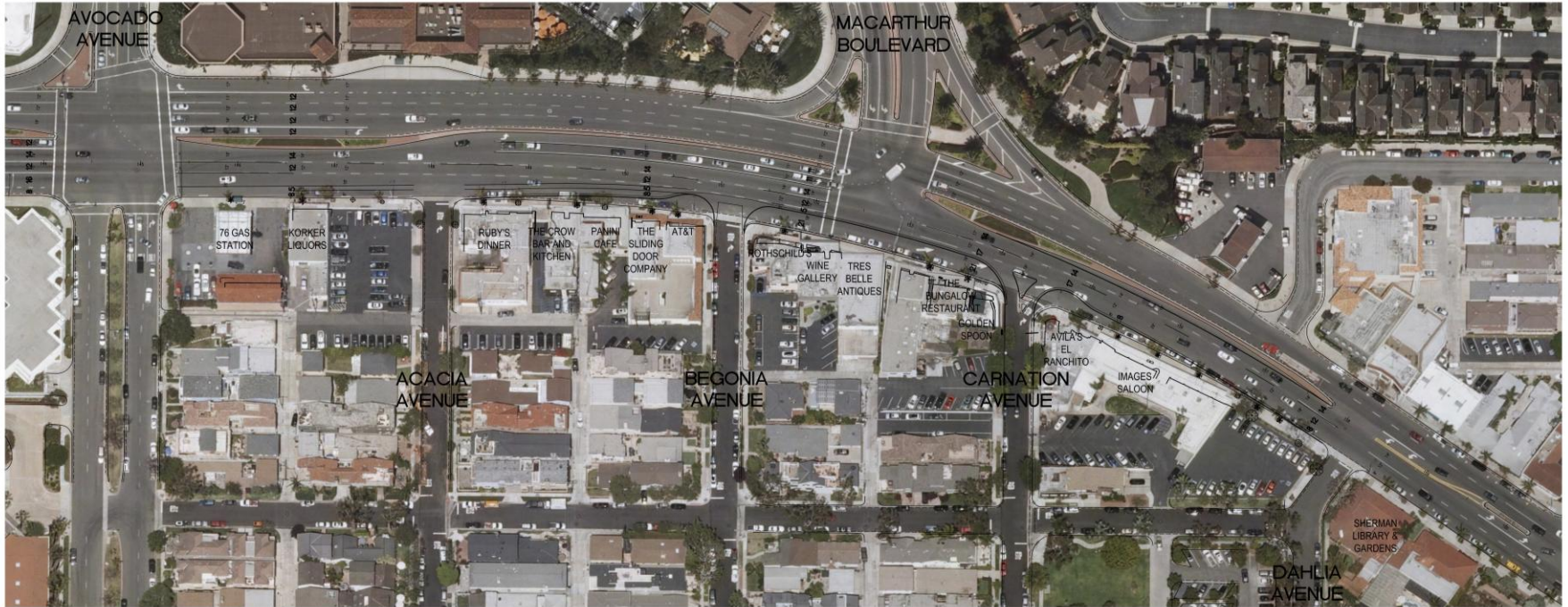

CORONA DEL MAR ENTRY IMPROVEMENTS
STUDY "C"

PARKWAY AND MEDIAN ENHANCEMENT
 WITH STREET PARKING

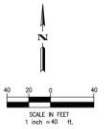

WALDEN & ASSOCIATES CIVIL ENGINEERS
 PLANNERS
 LAND SURVEYORS
 2552 WHITE ROAD, SUITE B, IRVINE, CA 92614
 (949) 660-0110 FAX: (949) 660-0418

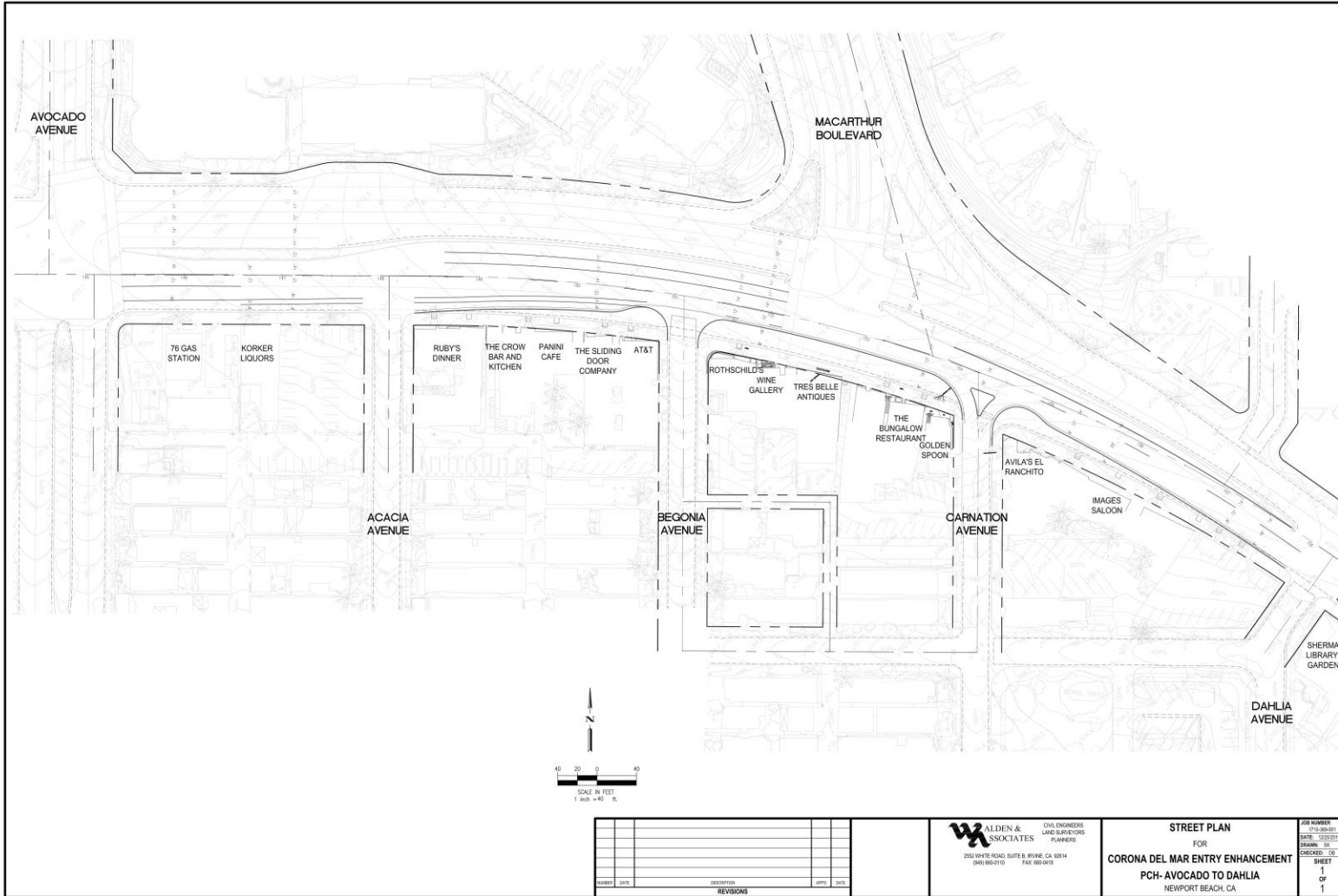

TREES



PHOENIX DACTYLIFERA
DATE PALM



OLEA EUROPAE (FRUITLESS)
OLIVE TREE



ARCHONTOPHOENIX CUNNINGHAMIANA
KING PALM. SEE OVERALL PLAN



SALWEENIA BLANCHIANA
HONG KONG ORCHID TREE. SEE OVERALL PLAN



CONCEPTUAL LANDSCAPE PLAN
CITY OF NEWPORT BEACH
CALIFORNIA
CORONA DEL MAR ENTRY



SHRUBS



STREPTOZIA REGINAE
BIRD OF PARADISE



HEMEROCALLIS HYBRID 'LEMON DIP'
DAYLEY



HEMEROCALLIS HYBRID 'BLACK SWAN'
DAYLEY



HEMEROCALLIS HYBRID 'PINK CHIFFON'
DAYLEY



TRACHELOSPERMUM JASMINOIDES (NELL)
STAR JASMINE



CAREX DIVULSA (C. TUMULCOLA)
BERKELEY SEDGE



LANTANA NEW GOLD
NEW GOLD LANTANA



ADIANTUM AFRICANUM PETER PAN
DWARF LILY OF THE NILE

















DISCUSSION AND DIRECTION





PUBLIC COMMENT

(3 MINUTES PER SPEAKER)



City Website for all Meeting Materials



<http://www.newportbeachca.gov/index.aspx?page=1959>





Next Meeting

JANUARY 25, 2012 @ 4:00 PM





ADJOURN



