



BUILDING DIVISION

STANDARD PRIVATE POOL/SPA DEMOLITION PLAN

LIMITS OF APPLICABILITY
 — USE OF THIS DOCUMENT SHALL NOT PERMIT THE APPLICANT TO MODIFY ANY PORTION(S) OF THIS PLAN OR THESE DETAILS.

In order to obtain a Pool Demolition Permit:

- Provide two sets of plans.
- Draw a site plan (aerial view) of your property in the space provided at the right-side of this sheet. See the "Example Site Plan" for the required information.
- Choose one of the following two methods that you will utilize to demolish the pool.

Method A- The "No Soils Engineer" Approach

- Leave shell.
- Remove the top 24" of the pool wall.
- Punch (2) - 3'x3' holes in bottom of pool shell at lowest locations.
- Fill pool shell with crushed rock to within 18" of surface.
- Use geotechnical filter cloth over rock.
- Cover with top soil and compact as needed to prevent future consolidation.

Method B- Use a Soil Engineer

- Remove shell completely.
- Fill hole per a soil engineer's recommendation and site observation of compaction, along with testing.
- Submit a copy of compaction report to the building inspector

For Both Methods

- Verify Site Drainage
- Inspector will verify the plumbing and electrical are properly abandoned.
- Obtain drainage permit (if drainage is altered or plumbing permit is adding or relocating area drains.

Alternate Method

- If an alternate demolition procedure is preferred, list the steps below. A plan check engineer will review it.

Alternate Method

EXAMPLE SITE PLAN

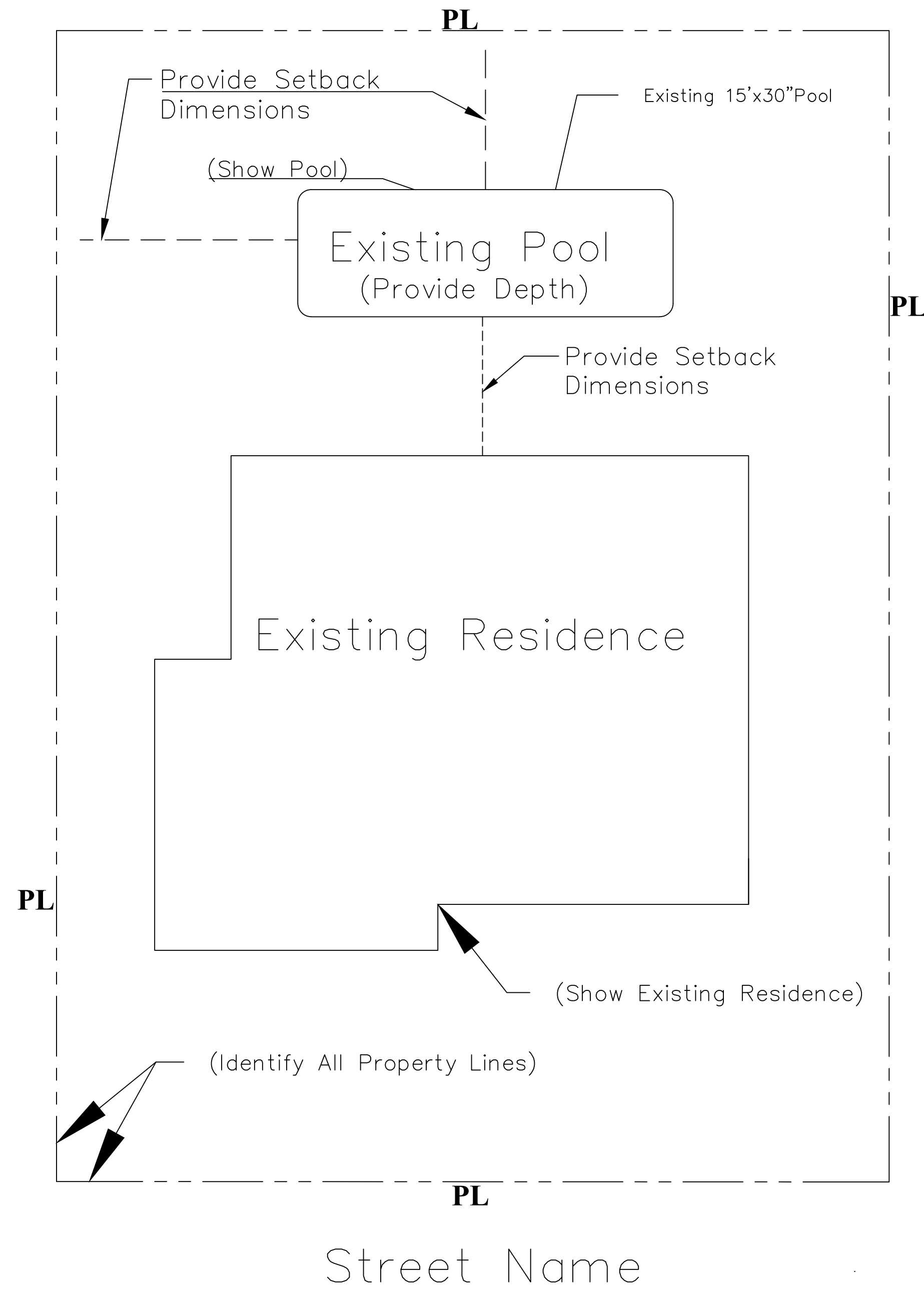

Demolish Existing Pool Using Method A
 — Identify Proposed Method of Pool Demolition

PROPOSED SITE PLAN

SCOPE OF WORK:	
PROJECT ADDRESS:	
OWNER'S NAME:	PLAN PREPARER:
TEL. NO.:	CONTACT INFO:
SIGNATURE:	LICENSE NO.: