

GALVANIZED POSTS	
POST I.D.	SLEEVE O.D.
PIPE	
5"	4.5"
6"	5.5"
SQ. TUBE	
5"X5"	4.75"X4.75"
6"X6"	5.75"X5.75"

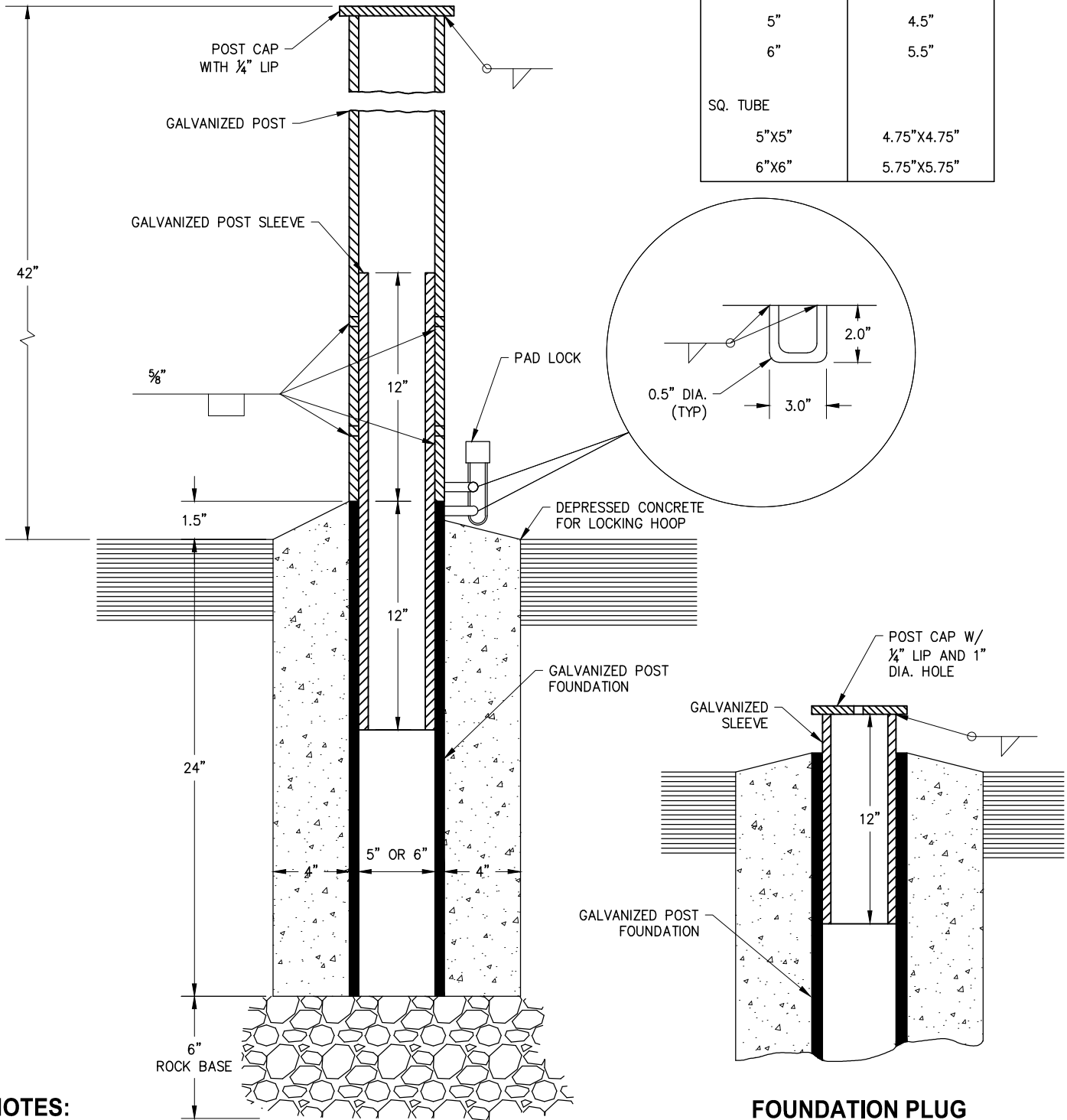

NOTES:

1. SEE STD 918 FOR SIZING AND SPACING REQUIREMENTS.
2. CONCRETE SHALL BE 560-C-3250.
3. ALL WELDS SHALL BE GROUND AND FINISHED SMOOTH.
4. BOLLARD SHALL HAVE RETROREFLECTIVE MATERIAL OR SIGNS PER CA MUTCD (LATEST EDITION).

FOUNDATION PLUG
FOR LONG TERM BOLLARD REMOVAL IN
HEAVY PEDESTRIAN/BICYCLE TRAFFIC AREAS

FORMER CITY STANDARD PLAN NUMBER (2004 EDITION): STD 917-L

APP. <i>James M. Hinkle</i>	51568	11/24/2020		
CITY ENGINEER	RCE	DATE		
			NO.	DATE
			DESCRIPTION OF REVISIONS	

CITY OF NEWPORT BEACH DEPARTMENT OF PUBLIC WORKS

DRAWN: P. KHARAZMI	<h1>REMOVABLE BOLLARD</h1>	STANDARD DRAWING NO.
DATE: 11/3/2020		<h2>917</h2>
		SHEET 1 OF 1