

AM/PM Split. Provide windows to all businesses and single entry communities in the area

SCALE: NTS

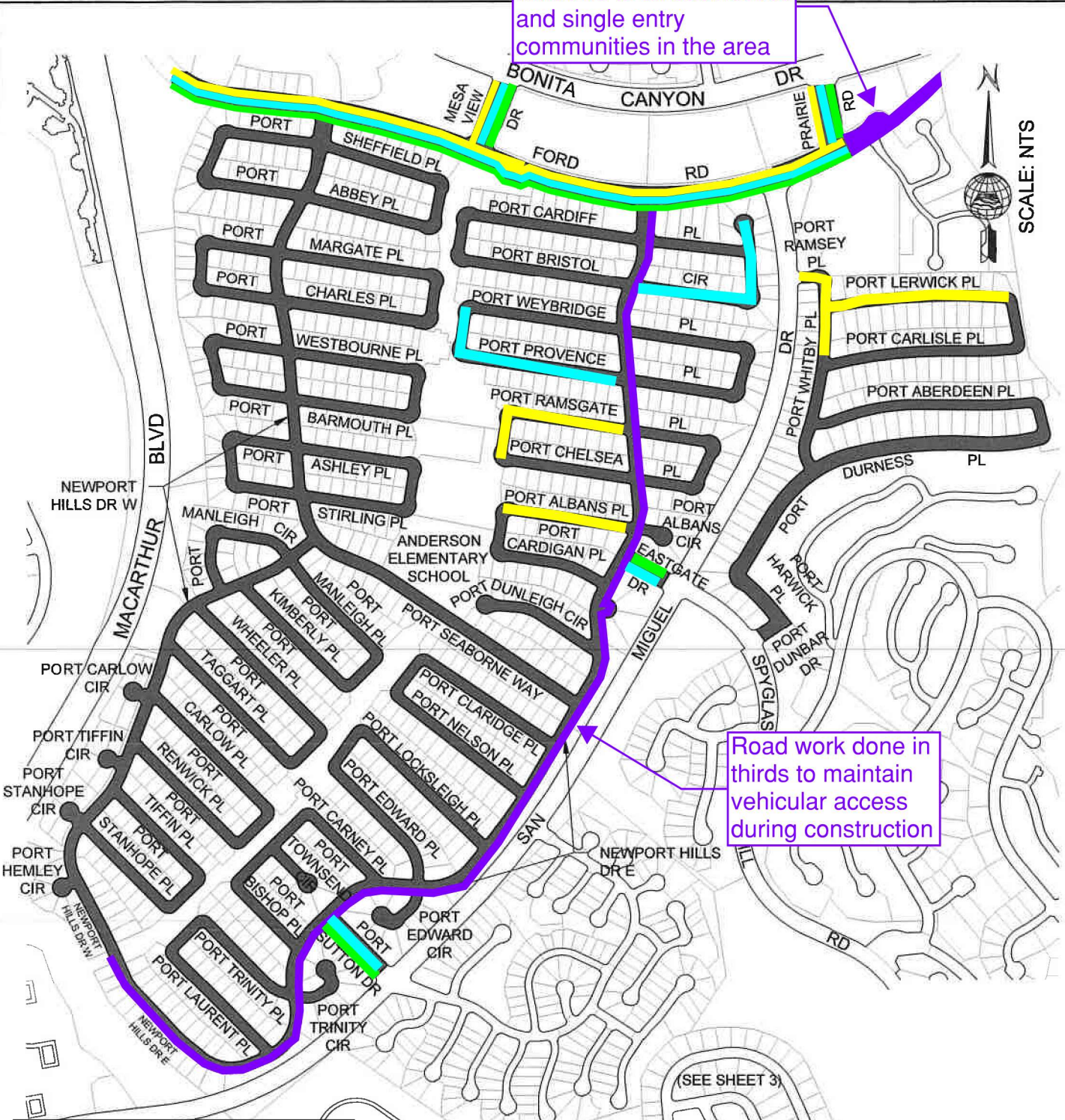

Road work done in thirds to maintain vehicular access during construction

MONDAY, 7/7	
TUESDAY, 7/8	
WEDNESDAY, 7/9	
THURSDAY, 7/10	
FRIDAY, 7/11	

**HARBOR VIEW, NEWPORT HILLS & SEAWIND**

**CITY OF NEWPORT BEACH**  
PUBLIC WORKS DEPARTMENT

**SLURRY SEAL PROGRAM**  
FY 2024-25

**Slurry Seal Schedule**  
Week of July 7 to July 11

DATE	PROJECT NO.	SHEET
02/20/2025	25R04	2 OF 11
DRAWN	C-9717-1	R-7046-L
TDP		

I:\Users\PBW\Shared\contracts\fy24-25 current\street\_drainage\slurry seal prgm c-9717\_25r04\DESIGN\100R Sub\Plans\SHEET15.2.dwg

Criss-crossed area will be completed in halves (one in AM, other in PM) in order to maintain access to Goleta Dr and Morro Bay

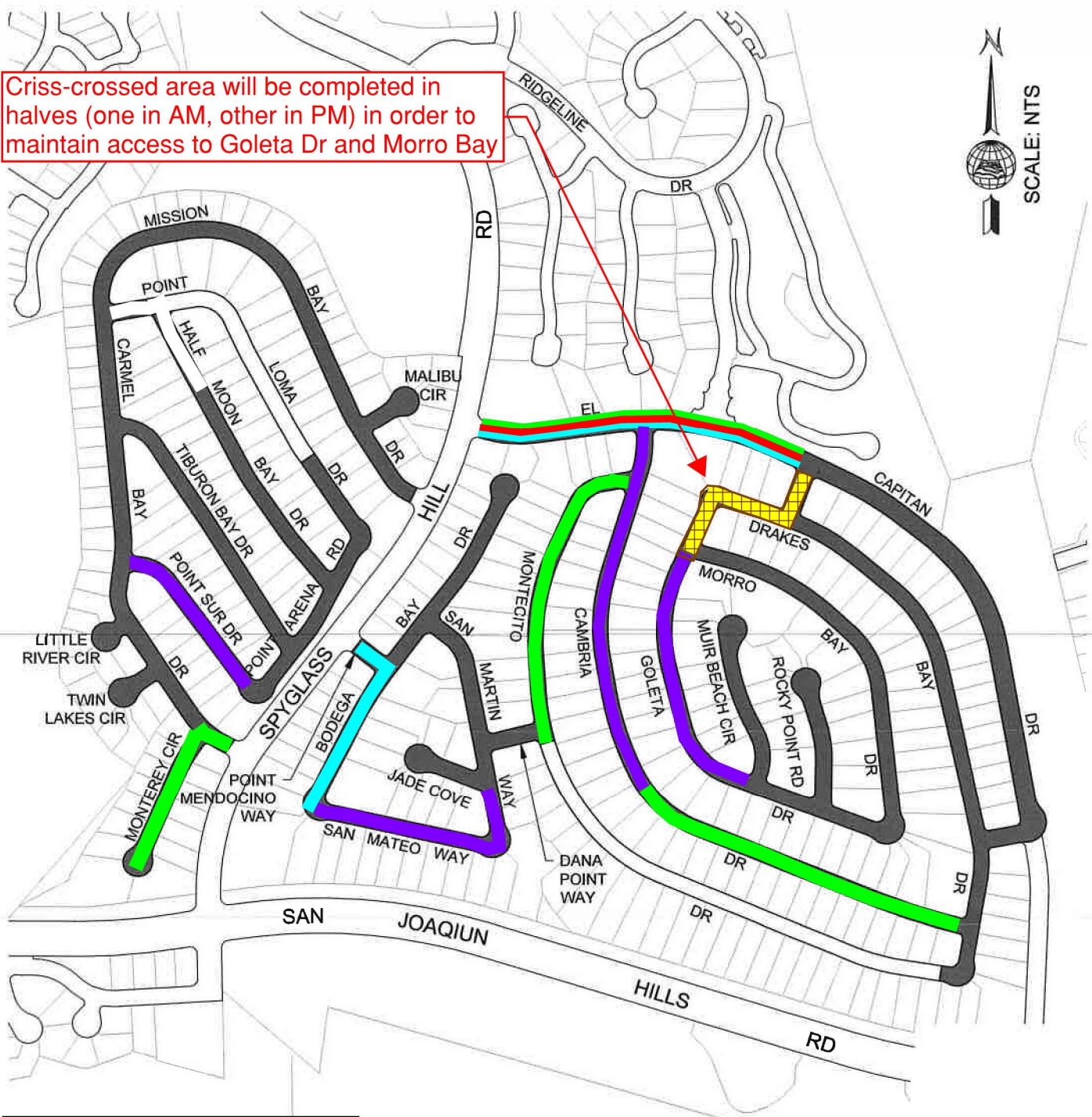

MONDAY, 7/7	
TUESDAY, 7/8	
WEDNESDAY, 7/9	
THURSDAY, 7/10	
FRIDAY, 7/11	

**SPYGLASS HILL**

**CITY OF NEWPORT BEACH**  
PUBLIC WORKS DEPARTMENT

**SLURRY SEAL PROGRAM**  
FY 2024-25

**Slurry Seal Schedule**  
Week of July 7 to July 11

DATE	PROJECT NO.	SHEET
02/20/2025	25R04	3 OF 11
DRAWN	C-9717-1	R-7046-L
TDP		

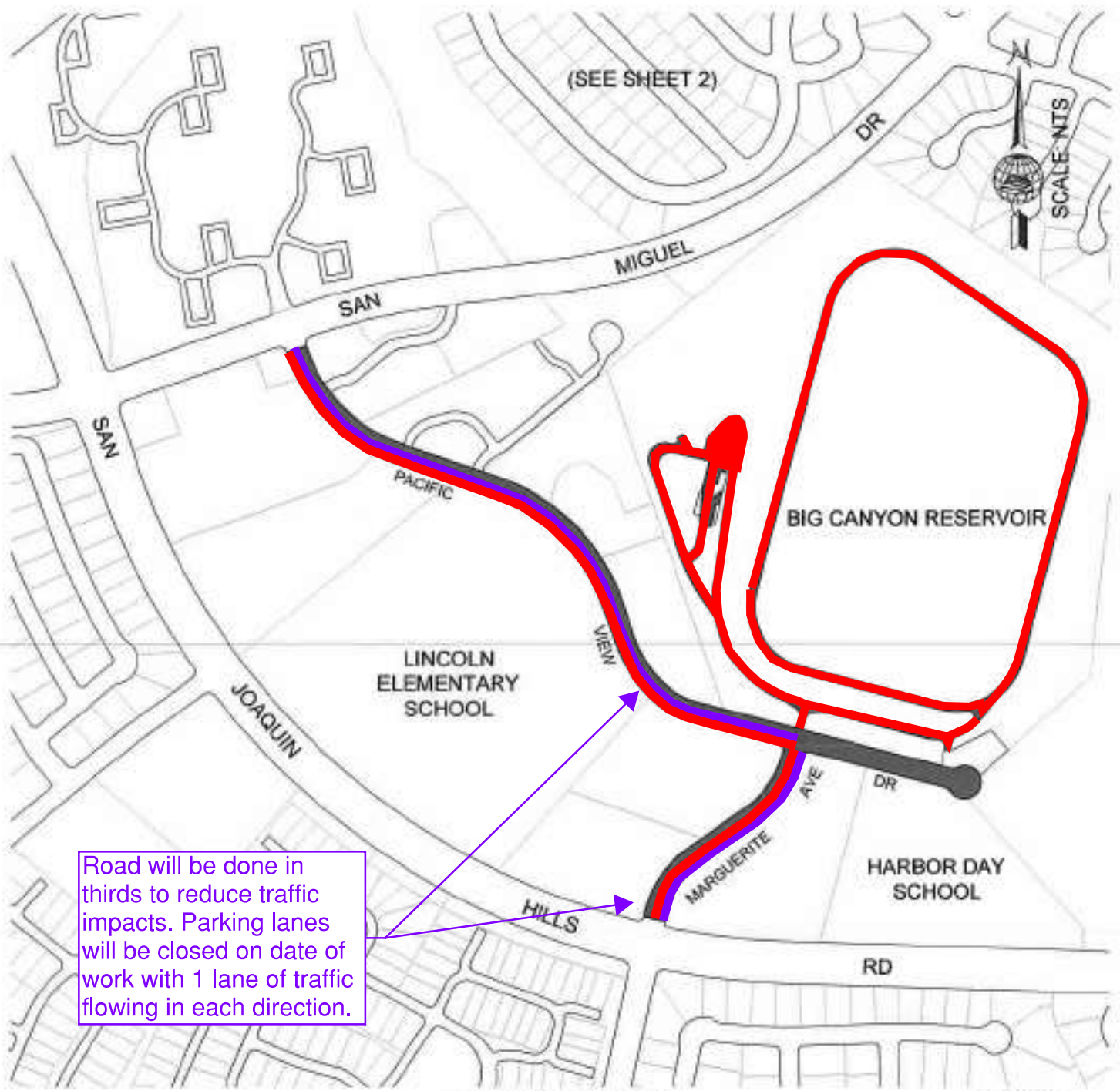

Road will be done in thirds to reduce traffic impacts. Parking lanes will be closed on date of work with 1 lane of traffic flowing in each direction.

MONDAY, 7/7	
TUESDAY, 7/8	
WEDNESDAY, 7/9	
THURSDAY, 7/10	
FRIDAY, 7/11	

**CITY OF NEWPORT BEACH**  
PUBLIC WORKS DEPARTMENT

**SLURRY SEAL PROGRAM**  
FY 2024-25

**Slurry Seal Schedule**  
Week of July 7 to July 11

DATE 02/20/2025	PROJECT NO. 25R04	SHEET 4 OF 11
DRAWN TDP	C-9717-1	R-7046-L

I:\Users\VBH\Shared\cstrzela\2024-25 current\200\_atroad\_drainage\slurry seal\pgrm c-9717-23\004\_DESIGN\1000 Sub Plans\SHEETS\4.rvt