

Western third of road width. Parking lanes will be closed on date of work with 1 lane of traffic flowing in each direction.

Work will be split into thirds. Parking lanes will be closed on date of work with 1 lane of traffic flowing in each direction.

Middle third of road width. Parking lanes will be closed on date of work with 1 lane of traffic flowing in each direction.

Final two thirds of road width. Parking lanes will be closed on dates of work with 1 lane of traffic flowing in each direction.

- MONDAY, 7/14
- TUESDAY, 7/15
- WEDNESDAY, 7/16
- THURSDAY, 7/17
- FRIDAY, 7/18

HARBOR VIEW, NEWPORT HILLS & SEAWIND

CITY OF NEWPORT BEACH
PUBLIC WORKS DEPARTMENT

SLURRY SEAL PROGRAM FY 2024-25

Slurry Seal Schedule
Week of July 14 to July 18

| | | |
|------------|-------------|----------|
| DATE | PROJECT NO. | SHEET |
| 02/20/2025 | 25R04 | 2 OF 11 |
| DRAWN | C-9717-1 | R-7046-L |
| TDP | | |

I:\Users\JPBW\Shored\contracts\fy24-25 current\200_street_drainage\slurry seal prgm c-9717-25r04\DESIGN\100% Sub\Plans\SHEETS\2.dwg

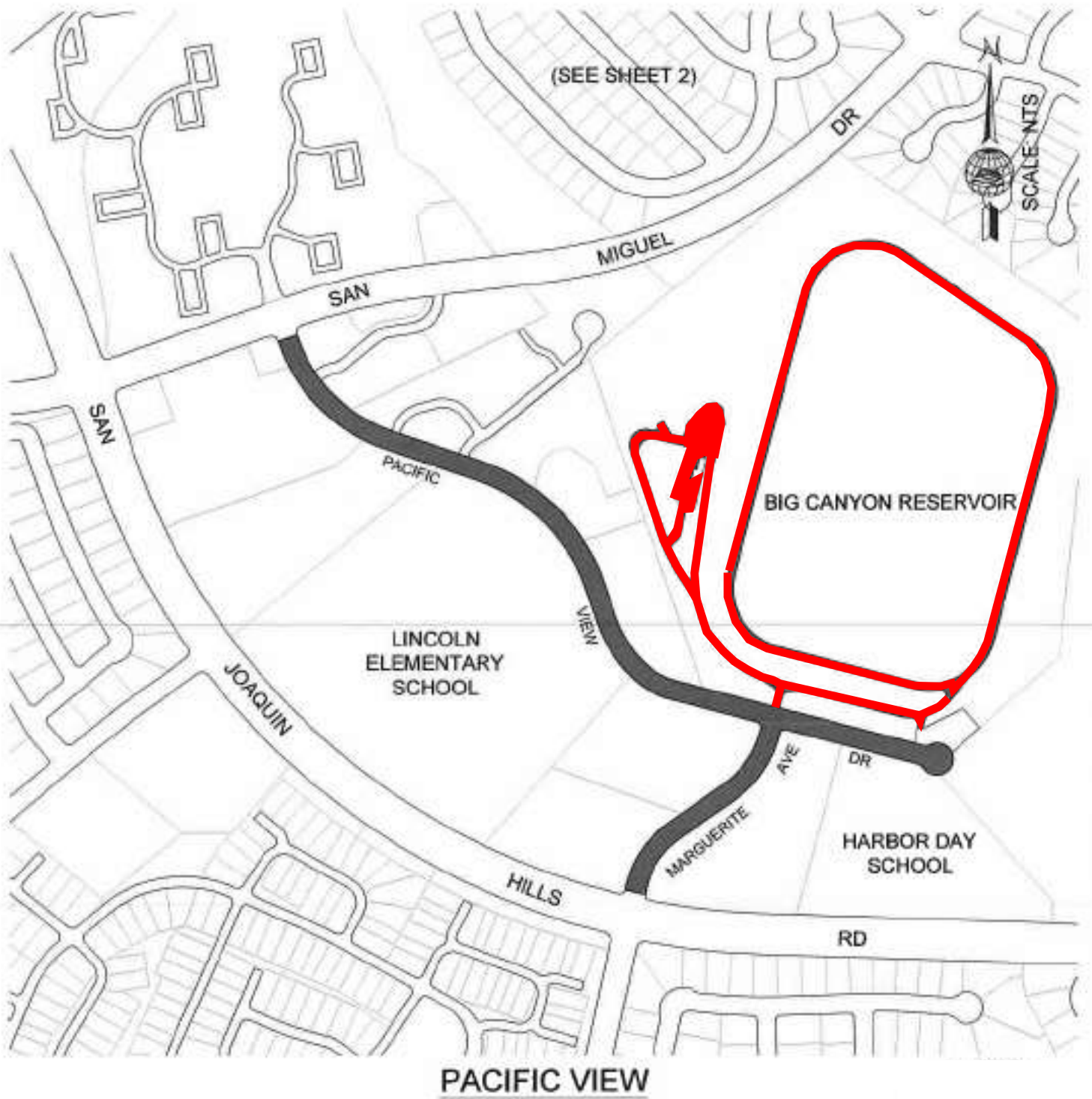

- MONDAY, 7/14
- TUESDAY, 7/15
- WEDNESDAY, 7/16
- THURSDAY, 7/17
- FRIDAY, 7/18

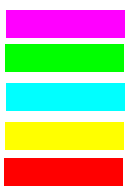

CITY OF NEWPORT BEACH
PUBLIC WORKS DEPARTMENT

SLURRY SEAL PROGRAM
FY 2024-25

Slurry Seal Schedule
Week of July 14 to July 18

| | | |
|------------|-------------|----------|
| DATE | PROJECT NO. | SHEET |
| 02/20/2025 | 25R04 | 4 OF 11 |
| DRAWN | C-9717-1 | R-7046-L |
| TDP | | |

I:\Users\VBH\Shared\Castro\2024-25 current\300_street_drainage\slurry seal\pgrm c-9717_25R04\DESIGN\300R Sub\Plans\SHEETS\4.rvt