

Exterior Signage

16 July 2007

NEWPORT PROFESSIONAL CENTER

496 N. Old Newport Blvd., Newport Beach, CA 92663-4226



Contact: John Clarke
(714) 558-3762
1607 E. Edinger Ave. #D
Newport Beach, CA 92663
PA2007-147 for CS2007-007
496 OLD NEWPORT BOULEVARD
Old Newport Medical Owners Association

For illustration purposes

NOTHING HEREIN SHALL BE CONSIDERED AS A GUARANTEE OF ANY KIND OR A WARRANTY OF ANY KIND, EITHER EXPRESS OR IMPLIED, BY THE ARCHITECT OR ANY OTHER PARTY. THE ARCHITECT'S LIABILITY IS LIMITED TO THE PROFESSIONAL SERVICES PROVIDED BY HIMSELF OR HIS FIRM. THE ARCHITECT SHALL NOT BE RESPONSIBLE FOR THE ACTIONS OR OMISSIONS OF ANY OTHER PARTY.

DATE: 05/09/07
 DRAWING NO.: 07-0001
 PROJECT: 496 Old Newport Blvd.
 SHEET: 01
 DRAWING DATE: May 9, 2007

PROJECT: 496 Old Newport Blvd.
 SHEET: 01
 DRAWING DATE: May 9, 2007

PROJECT: 496 Old Newport Blvd.
 SHEET: 01
 DRAWING DATE: May 9, 2007

PROJECT: 496 Old Newport Blvd.
 SHEET: 01
 DRAWING DATE: May 9, 2007

PROJECT: 496 Old Newport Blvd.
 SHEET: 01
 DRAWING DATE: May 9, 2007

PROJECT: 496 Old Newport Blvd.
 SHEET: 01
 DRAWING DATE: May 9, 2007

PROJECT: 496 Old Newport Blvd.
 SHEET: 01
 DRAWING DATE: May 9, 2007

PROJECT: 496 Old Newport Blvd.
 SHEET: 01
 DRAWING DATE: May 9, 2007

PROJECT: 496 Old Newport Blvd.
 SHEET: 01
 DRAWING DATE: May 9, 2007

PROJECT: 496 Old Newport Blvd.
 SHEET: 01
 DRAWING DATE: May 9, 2007

PROJECT: 496 Old Newport Blvd.
 SHEET: 01
 DRAWING DATE: May 9, 2007

PROJECT: 496 Old Newport Blvd.
 SHEET: 01
 DRAWING DATE: May 9, 2007

West Facing

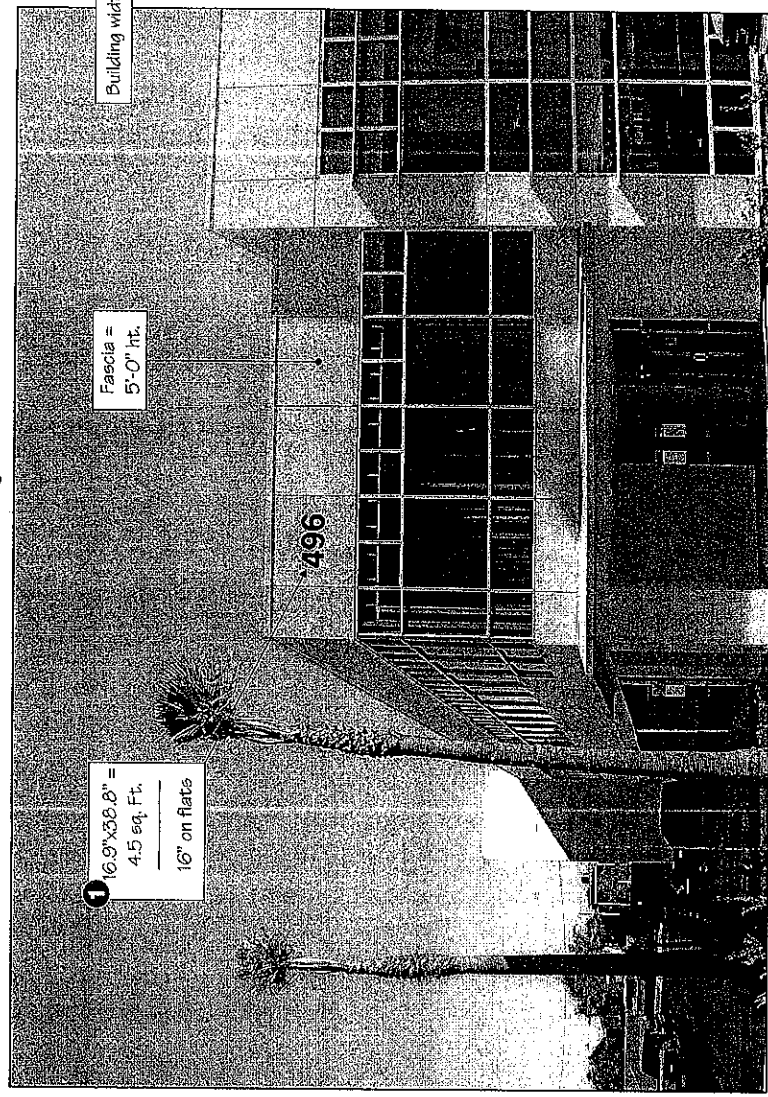

Building width = 97 ft.

Fascia = 5'-0" ht.

1 16.9" x 38.8" = 4.5 sq. Ft. 16" on flats

Old Newport Blvd.

1 set

1 Specification:
 Exterior wall numbers - 16" x 1/4" (on flats) dimensional aluminum face and returns to be powder coated black / font - Helvetica med. mounting - pinned flush to stucco fascia

for illustration purposes

West Facing

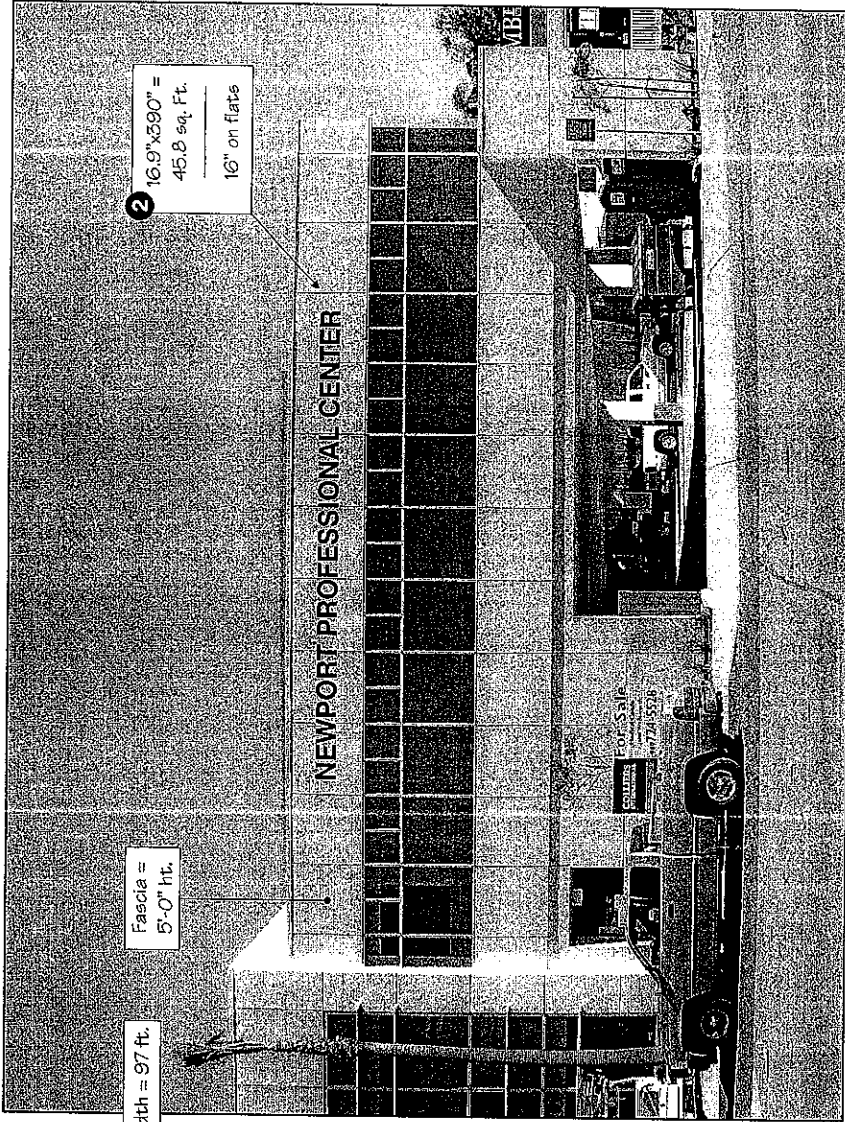

2

Specification:
 Exterior wall numbers - 16" x 1/4" (on flats) dimensional aluminum
 face and returns to be powder coated black / font - Helvetica med.
 mounting - pinned flush to stucco fascia

Old Newport Blvd.

1 set

For illustration purposes

CLARKE & ASSOCIATES
 1007 EAST BROADWAY UNIT D
 SANTA ANA, CA 92705
 Phone: 714.558.3782
 Fax: 714.973.1738
 E-Mail: info@clarkeandassociates.com

Professional project number: 01-000000-000000
 Project name: Newport Professional Center
 Project location: 488 Old Newport Blvd., N.B., CA
 Project description: Exterior Wall Sign Building ID
 Date of issue: 05/09/2007
 Drawing title: Exterior Wall Sign Building ID

Revision 01: 05/09/2007, 08:00 AM
 Revision 02: 05/09/2007, 08:00 AM
 Revision 03: 05/09/2007, 08:00 AM
 Revision 04: 05/09/2007, 08:00 AM
 Revision 05: 05/09/2007, 08:00 AM
 Revision 06: 05/09/2007, 08:00 AM
 Revision 07: 05/09/2007, 08:00 AM
 Revision 08: 05/09/2007, 08:00 AM
 Revision 09: 05/09/2007, 08:00 AM
 Revision 10: 05/09/2007, 08:00 AM
 Revision 11: 05/09/2007, 08:00 AM
 Revision 12: 05/09/2007, 08:00 AM
 Revision 13: 05/09/2007, 08:00 AM
 Revision 14: 05/09/2007, 08:00 AM
 Revision 15: 05/09/2007, 08:00 AM
 Revision 16: 05/09/2007, 08:00 AM
 Revision 17: 05/09/2007, 08:00 AM
 Revision 18: 05/09/2007, 08:00 AM
 Revision 19: 05/09/2007, 08:00 AM
 Revision 20: 05/09/2007, 08:00 AM
 Revision 21: 05/09/2007, 08:00 AM
 Revision 22: 05/09/2007, 08:00 AM
 Revision 23: 05/09/2007, 08:00 AM
 Revision 24: 05/09/2007, 08:00 AM
 Revision 25: 05/09/2007, 08:00 AM
 Revision 26: 05/09/2007, 08:00 AM
 Revision 27: 05/09/2007, 08:00 AM
 Revision 28: 05/09/2007, 08:00 AM
 Revision 29: 05/09/2007, 08:00 AM
 Revision 30: 05/09/2007, 08:00 AM
 Revision 31: 05/09/2007, 08:00 AM
 Revision 32: 05/09/2007, 08:00 AM
 Revision 33: 05/09/2007, 08:00 AM
 Revision 34: 05/09/2007, 08:00 AM
 Revision 35: 05/09/2007, 08:00 AM
 Revision 36: 05/09/2007, 08:00 AM
 Revision 37: 05/09/2007, 08:00 AM
 Revision 38: 05/09/2007, 08:00 AM
 Revision 39: 05/09/2007, 08:00 AM
 Revision 40: 05/09/2007, 08:00 AM
 Revision 41: 05/09/2007, 08:00 AM
 Revision 42: 05/09/2007, 08:00 AM
 Revision 43: 05/09/2007, 08:00 AM
 Revision 44: 05/09/2007, 08:00 AM
 Revision 45: 05/09/2007, 08:00 AM
 Revision 46: 05/09/2007, 08:00 AM
 Revision 47: 05/09/2007, 08:00 AM
 Revision 48: 05/09/2007, 08:00 AM
 Revision 49: 05/09/2007, 08:00 AM
 Revision 50: 05/09/2007, 08:00 AM
 Revision 51: 05/09/2007, 08:00 AM
 Revision 52: 05/09/2007, 08:00 AM
 Revision 53: 05/09/2007, 08:00 AM
 Revision 54: 05/09/2007, 08:00 AM
 Revision 55: 05/09/2007, 08:00 AM
 Revision 56: 05/09/2007, 08:00 AM
 Revision 57: 05/09/2007, 08:00 AM
 Revision 58: 05/09/2007, 08:00 AM
 Revision 59: 05/09/2007, 08:00 AM
 Revision 60: 05/09/2007, 08:00 AM
 Revision 61: 05/09/2007, 08:00 AM
 Revision 62: 05/09/2007, 08:00 AM
 Revision 63: 05/09/2007, 08:00 AM
 Revision 64: 05/09/2007, 08:00 AM
 Revision 65: 05/09/2007, 08:00 AM
 Revision 66: 05/09/2007, 08:00 AM
 Revision 67: 05/09/2007, 08:00 AM
 Revision 68: 05/09/2007, 08:00 AM
 Revision 69: 05/09/2007, 08:00 AM
 Revision 70: 05/09/2007, 08:00 AM
 Revision 71: 05/09/2007, 08:00 AM
 Revision 72: 05/09/2007, 08:00 AM
 Revision 73: 05/09/2007, 08:00 AM
 Revision 74: 05/09/2007, 08:00 AM
 Revision 75: 05/09/2007, 08:00 AM
 Revision 76: 05/09/2007, 08:00 AM
 Revision 77: 05/09/2007, 08:00 AM
 Revision 78: 05/09/2007, 08:00 AM
 Revision 79: 05/09/2007, 08:00 AM
 Revision 80: 05/09/2007, 08:00 AM
 Revision 81: 05/09/2007, 08:00 AM
 Revision 82: 05/09/2007, 08:00 AM
 Revision 83: 05/09/2007, 08:00 AM
 Revision 84: 05/09/2007, 08:00 AM
 Revision 85: 05/09/2007, 08:00 AM
 Revision 86: 05/09/2007, 08:00 AM
 Revision 87: 05/09/2007, 08:00 AM
 Revision 88: 05/09/2007, 08:00 AM
 Revision 89: 05/09/2007, 08:00 AM
 Revision 90: 05/09/2007, 08:00 AM
 Revision 91: 05/09/2007, 08:00 AM
 Revision 92: 05/09/2007, 08:00 AM
 Revision 93: 05/09/2007, 08:00 AM
 Revision 94: 05/09/2007, 08:00 AM
 Revision 95: 05/09/2007, 08:00 AM
 Revision 96: 05/09/2007, 08:00 AM
 Revision 97: 05/09/2007, 08:00 AM
 Revision 98: 05/09/2007, 08:00 AM
 Revision 99: 05/09/2007, 08:00 AM
 Revision 100: 05/09/2007, 08:00 AM

Stamp / Signature:

Job Number:	
Client:	
Drawn by:	A. Dwyer
Date issued:	May 2007
File Name:	488 Old Newport Blvd - N.B. - CA
Scale:	1/4" = 1'-0"
Author:	
Checked by:	
Date:	
Changes:	
By:	
Check:	

Project/Contract No.:
 Newport Professional
 Center
 488 Old Newport Blvd., N.B., CA
 Drawing Title:
 Exterior Wall Sign
 Building ID
 Date:
 May 9, 2007

Sheet No.:	2
Total Sheets:	



CLARKE & ASSOCIATES
ARCHITECTS AND ENGINEERS
SANTA ANA, CALIFORNIA

Phone: 714.641.1172
Fax: 714.643.7128
Email: info@cla-and-a.com

Notwithstanding to whom these drawings are delivered, the user of these drawings shall be deemed to have accepted the drawings as shown and shall be responsible for any errors or omissions and for any consequences arising therefrom. The user shall indemnify and hold the architect harmless from any and all claims, damages, costs and expenses, including reasonable attorneys' fees, that may be incurred by the architect as a result of the user's use of these drawings.

TOLERANCES
FINISHES
ELECTRICAL
MECHANICAL
PLUMBING
WOODWORK
CONCRETE
MASONRY
PAINTS & COATINGS

Unless otherwise noted, all dimensions are in feet and inches. Dimensions are given in feet and inches unless otherwise specified. Dimensions in feet are given in feet and inches unless otherwise specified. Dimensions in inches are given in inches unless otherwise specified.

Sheet / Signature:

AP: [Blank]
Checked: [Blank]
Drawn by: A. Barling
Date Issued: 9 May 2007
File Name: 04 CC (Professional) 01.dwg
Scale: [Blank]
Name and Title: [Blank]
Date: [Blank]

By: [Blank]
Date: [Blank]

Project Name: [Blank]
Project Location: [Blank]

Project Title: [Blank]

Project Number: [Blank]

Project Address: [Blank]

Project City: [Blank]

Project State: [Blank]

Project Zip: [Blank]

Project Client: [Blank]

Project Architect: [Blank]

Project Date: [Blank]

Project Title: [Blank]

Project Number: [Blank]

Project Address: [Blank]

Project City: [Blank]

Project State: [Blank]

Project Zip: [Blank]

West Facing

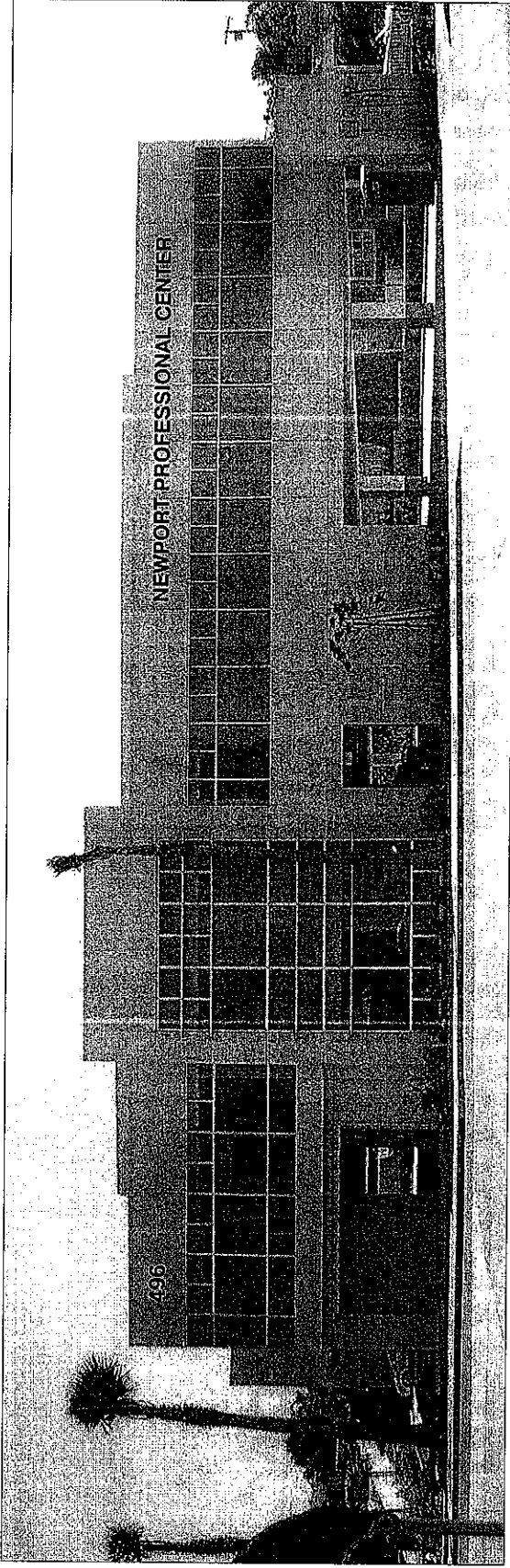

Orange Ave.

Old Newport Blvd.

Entire building west face - reference only.
1/8" characters

For illustration purposes

10.

Individual project needs. All items and materials are to be specified in the drawing and the contractor is to be responsible for obtaining all necessary permits and approvals. The contractor is to be responsible for obtaining all necessary permits and approvals. The contractor is to be responsible for obtaining all necessary permits and approvals.

PROJECT NO.	1154
DATE	05/09/07
PROJECT NAME	NEWPORT PROFESSIONAL CENTER
CLIENT	NEWPORT PROFESSIONAL CENTER
LOCATION	486 OLD NEWPORT BLVD., N.B., CA
SCALE	1/4" = 1'-0"
DATE	05/09/07
BY	CL

At alternative per approved set of drawings, the contractor is to be responsible for obtaining all necessary permits and approvals. The contractor is to be responsible for obtaining all necessary permits and approvals. The contractor is to be responsible for obtaining all necessary permits and approvals.

DATE	05/09/07
BY	CL
PROJECT NO.	1154
DATE	05/09/07
PROJECT NAME	NEWPORT PROFESSIONAL CENTER
CLIENT	NEWPORT PROFESSIONAL CENTER
LOCATION	486 OLD NEWPORT BLVD., N.B., CA
SCALE	1/4" = 1'-0"
DATE	05/09/07
BY	CL

At alternative per approved set of drawings, the contractor is to be responsible for obtaining all necessary permits and approvals. The contractor is to be responsible for obtaining all necessary permits and approvals. The contractor is to be responsible for obtaining all necessary permits and approvals.

DATE	05/09/07
BY	CL
PROJECT NO.	1154
DATE	05/09/07
PROJECT NAME	NEWPORT PROFESSIONAL CENTER
CLIENT	NEWPORT PROFESSIONAL CENTER
LOCATION	486 OLD NEWPORT BLVD., N.B., CA
SCALE	1/4" = 1'-0"
DATE	05/09/07
BY	CL

At alternative per approved set of drawings, the contractor is to be responsible for obtaining all necessary permits and approvals. The contractor is to be responsible for obtaining all necessary permits and approvals. The contractor is to be responsible for obtaining all necessary permits and approvals.

DATE	05/09/07
BY	CL
PROJECT NO.	1154
DATE	05/09/07
PROJECT NAME	NEWPORT PROFESSIONAL CENTER
CLIENT	NEWPORT PROFESSIONAL CENTER
LOCATION	486 OLD NEWPORT BLVD., N.B., CA
SCALE	1/4" = 1'-0"
DATE	05/09/07
BY	CL

At alternative per approved set of drawings, the contractor is to be responsible for obtaining all necessary permits and approvals. The contractor is to be responsible for obtaining all necessary permits and approvals. The contractor is to be responsible for obtaining all necessary permits and approvals.

DATE	05/09/07
BY	CL
PROJECT NO.	1154
DATE	05/09/07
PROJECT NAME	NEWPORT PROFESSIONAL CENTER
CLIENT	NEWPORT PROFESSIONAL CENTER
LOCATION	486 OLD NEWPORT BLVD., N.B., CA
SCALE	1/4" = 1'-0"
DATE	05/09/07
BY	CL

At alternative per approved set of drawings, the contractor is to be responsible for obtaining all necessary permits and approvals. The contractor is to be responsible for obtaining all necessary permits and approvals. The contractor is to be responsible for obtaining all necessary permits and approvals.

DATE	05/09/07
BY	CL
PROJECT NO.	1154
DATE	05/09/07
PROJECT NAME	NEWPORT PROFESSIONAL CENTER
CLIENT	NEWPORT PROFESSIONAL CENTER
LOCATION	486 OLD NEWPORT BLVD., N.B., CA
SCALE	1/4" = 1'-0"
DATE	05/09/07
BY	CL

At alternative per approved set of drawings, the contractor is to be responsible for obtaining all necessary permits and approvals. The contractor is to be responsible for obtaining all necessary permits and approvals. The contractor is to be responsible for obtaining all necessary permits and approvals.

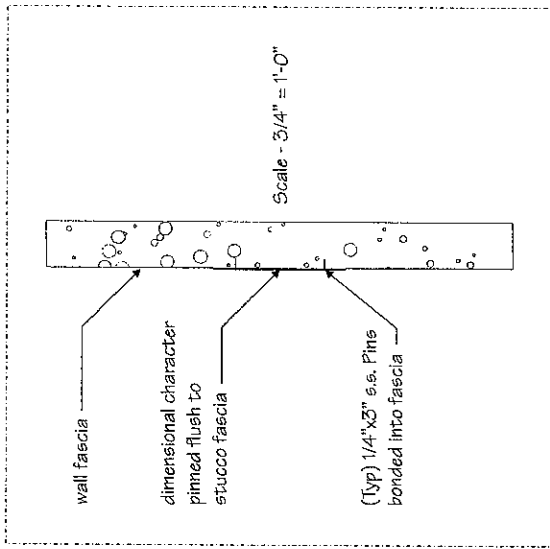

4.5 sq. Ft. + 45.8 sq. Ft.
= 50.3 sq. ft. Total
97 ft. / 15 (linear ft.)
= 64.67 sq. ft. allowable

16.9" x 39.0" =
45.8 sq. Ft.
16" on flats

16.9" x 38.8" =
4.5 sq. Ft.
16" on flats

38.8"
1 496

32' - 6"
2 NEWPORT PROFESSIONAL CENTER

Specification:
Exterior wall numbers and letters - 16"x1/4" (on flats) dimensional aluminum face and returns to be powder coated black / font - Helvetica med. mounting - pinned flush to stucco fascia

Scale - 3/8" = 1'-0"
1 set ea.

For illustration purposes



CLARKE & ASSOCIATES
ARCHITECTS
3000 W. 10TH ST., SUITE 100
SANTA ANA, CA 92705

Phone: 714.554.5762
Fax: 714.573.7788
Email: info@clarkeandassociates.com

INDICATE PROJECT NAME, ADDRESS AND SHEET NUMBER OF SHEET TO WHICH THIS DRAWING IS TO BE REFERRED. THIS DRAWING IS TO BE USED ONLY FOR THE PROJECT AND SITE SPECIFICALLY IDENTIFIED HEREIN. ANY REUSE OF THIS DRAWING FOR ANY OTHER PROJECT IS STRICTLY PROHIBITED. THE USER ASSUMES ALL LIABILITY FOR ANY AND ALL DAMAGES, INCLUDING REASONABLE ATTORNEY'S FEES, ARISING FROM ANY REUSE OF THIS DRAWING.

DATE: 05/09/07
DRAWN BY: [blank]
CHECKED BY: [blank]
SCALE: 1/32" = 1'-0"
SHEET NO.: 5
DATE: 05/09/07

Front View Elevation

Scale - 1/32" = 1'-0"

- ① 496
- ② NEWPORT PROFESSIONAL CENTER
4.5 sq. ft. + 45.8 sq. ft. = 50.3 sq. ft.

all characters 16"x1/4"
black powder coated
aluminum, pin mounted
flush to stucco fascia.

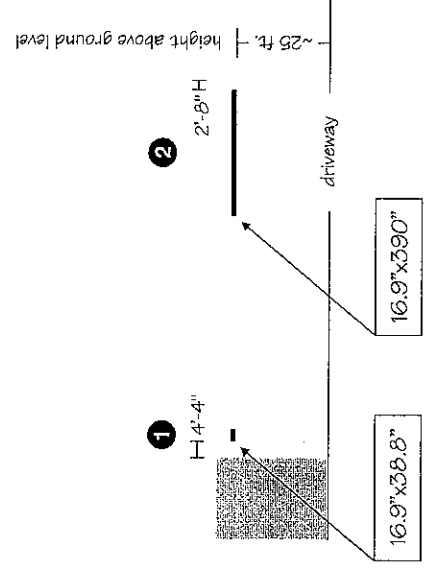

Plot Top View

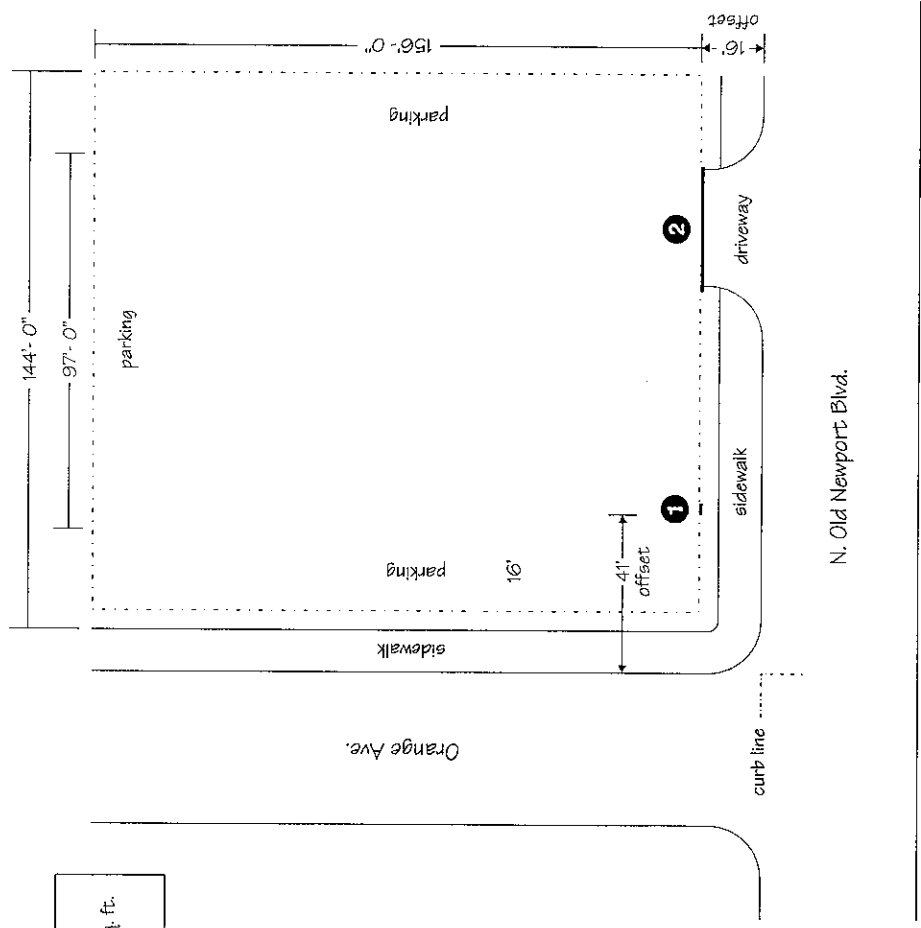

For illustration purposes