



**CITY OF NEWPORT BEACH
COMMUNITY DEVELOPMENT DEPARTMENT
PLANNING DIVISION ACTION REPORT**

TO: CITY COUNCIL, CITY MANAGER AND PLANNING COMMISSION

FROM: Kimberly Brandt, Community Development Director
Brenda Wisneski, Deputy Community Development Director

SUBJECT: Report of actions taken by the Zoning Administrator and/or Planning Division staff for the week ending November 23, 2012

**COMMUNITY DEVELOPMENT DIRECTOR
OR PLANNING DIVISION STAFF ACTIONS**

- Item 1: Trees by the Sea Christmas Tree Lot – Limited Term Permit – Seasonal No. XP2012-004 (PA2012-152)
1520 W. Coast Highway
- Action: Approved Council District 3
- Item 2: Gallo’s Christmas Tree Lot – Limited Term Permit – Seasonal No. XP2012-006 (PA2012-156)
3928 E. Coast Highway
- Action: Approved Council District 6
- Item 3: Newport Dunes Resort and Marina Christmas Tree Lot - Seasonal No. XP2012-007 (PA2012-157)
1131 Back Bay Drive
- Action: Approved Council District 5

APPEAL PERIOD: An appeal may be filed with the Director of Community Development or City Clerk, as applicable, within fourteen (14) days following the date the action or decision was rendered unless a different period of time is specified by the Municipal Code (e.g., Title 19 allows ten (10) day appeal period for tentative parcel and tract maps, lot line adjustments, or lot mergers). For additional information on filing an appeal, contact the Planning Division at 949 644-3200.



COMMUNITY DEVELOPMENT DEPARTMENT
PLANNING DIVISION

3300 Newport Boulevard, Building C, Newport Beach, CA 92663
(949) 644-3200 Fax: (949) 644-3229

www.newportbeachca.gov

ZONING ADMINISTRATOR ACTION LETTER

Application No. Limited Term Permit – Seasonal No. XP2012-004
(PA2012-152)

Applicant Lauren Mitchell

Site Address 1520 W. Coast Highway
Trees by the Sea Christmas Tree Lot

Legal Description Tract 1210, Lot 54 and a portion of Lots 55 & 56. Parcel 2 of
Lot Line Adjustment LLA_95-01

On **November 19, 2012**, the Zoning Administrator approved the following: A Limited Term Permit application, No. XP2012-004, for a Christmas tree sales lot (seasonal sales) at a vacant commercial site previously occupied by a vehicle/equipment repair facility. The property is located in the CG (Commercial General) Zoning District. The Zoning Administrator's approval is based on the following findings and subject to the following conditions.

FINDINGS

1. **Finding:** This project has been reviewed, and it has been determined that it is categorically exempt from the requirements of the California Environmental Quality Act under Class 4 (Sec. 15304 Minor Alternations to Land).

Facts in Support of Finding:

- Class 4 exempts minor temporary uses of land having negligible or no permanent effects on the environment, including carnivals, sales of Christmas trees, etc.
2. **Finding:** The operation of the requested limited duration use at the location proposed and within the time period specified would not be detrimental to the harmonious and orderly growth of the City, nor endanger, jeopardize, or otherwise constitute a hazard to the public convenience, health, interest, safety, or general welfare of persons residing or working in the neighborhood of the requested limited duration use;

Facts in Support of Finding:

- The operation of the temporary Christmas tree sales lot has been reviewed and conditioned to preclude any detriment and to uphold the general welfare of the area.
3. **Finding:** The subject lot is adequate in size and shape to accommodate the limited duration use without material detriment to the use and enjoyment of other properties located adjacent to and in the vicinity of the lot;

Facts in Support of Finding:

- The subject lot is approximately 13,700 square feet and is currently developed with a 4,909-square-foot commercial building.
 - The proposed site plan includes a 600-square-foot tree sales area (20x30), a tree stand installation and cutting area, and a cash wrap/restroom area within a portion of the existing commercial building.
 - All temporary structures and improvements will be erected on private property.
4. **Finding:** The subject lot is adequately served by streets or highways having sufficient width and improvements to accommodate the kind and quantity of traffic that the limited duration use would or could reasonably be expected to generate;

Facts in Support of Finding:

- The subject lot has one driveway approach accessed directly from West Coast Highway.
5. **Finding:** Adequate temporary parking to accommodate vehicular traffic to be generated by the limited duration use would be available either on-site or at alternate locations acceptable to the Zoning Administrator; and

Facts in Support of Finding:

- The Christmas tree sales lot is not anticipated to generate an excess of vehicular traffic.
 - Adequate temporary parking will be provided by way of the eight (8) spaces located on the lot.
6. **Finding:** The limited duration use is consistent with all applicable provisions of the General Plan, any applicable specific plan, the Municipal Code, and other City regulations.

Facts in Support of Finding:

- The Christmas tree sales lot is conditioned such that it will comply with all applicable provisions of the General Plan, Municipal Code, and other City regulations.
- The subject lot is not located within any specific plan.

CONDITIONS

1. The limited duration use shall not commence operation prior to November 23, 2012 and shall conclude by December 26, 2012.
2. All temporary structures shall be anchored and a building permit shall be secured for those structures as required by the Building Division.
3. Inspection of all temporary structures is required by a Building Division Inspector. Permittee shall comply with all lawful orders and requirements of the Building Inspector. Inspection approval is required before the canopy can be entered by the public.
4. The limited duration use shall only operate between the hours of 9:00 a.m. and 9:00 p.m., daily.
5. The operator of the limited duration use shall be responsible for the control of noise generated by the subject facility including, but not limited to, noise generated by patrons and equipment. All noise generated by the proposed use shall comply with the provisions of Chapter 10.26 and other applicable noise control requirements of the Newport Beach Municipal Code. If noise generation does not comply with the aforementioned provisions, the Community Development Director may require remediation measures which may include relocation of equipment.
6. Lighting shall be in compliance with applicable standards of the Zoning Code. Exterior on-site lighting shall be shielded and confined within site boundaries. No direct rays or glare are permitted to shine onto public streets or adjacent sites or create a public nuisance. "Walpak" type fixtures are not permitted. If in the opinion of the Community Development Director, existing illumination creates an unacceptable negative impact on surrounding land uses or sensitive habitat areas he or she may order the dimming of light sources or other remediation upon finding that the site is excessively illuminated. An electrical permit shall be secured for lighting as required by the Building Division.
7. All electrical shall be in good working order and shall be protected from pedestrian traffic.
8. Accommodations for accessibility shall be provided.

9. One (1) parking space with 8 foot loading zone shall be marked and signed for the disabled for the limited duration of use, in compliance with the Americans with Disabilities Act (ADA), 2012 California Building Code, and subject to signage standards set forth by the Building Department.
10. The parking space closest to the trash enclosure shall be utilized as a designated turnaround area and shall be posted with a sign such that no parking is permitted.
11. The site driveway access shall have adequate sight distance pursuant to City Standard STD-110-L.
12. The applicant shall ensure patron vehicles do not impact traffic flow on West Coast Highway.
13. The site shall be cleaned of debris, litter, or any other evidence of the limited duration use upon completion or removal of the use, and shall continue to be used in compliance with this Zoning Code. The site shall be adequately cleaned and inspected by Code Enforcement by midnight on December 31, 2012. Failure to do so will result in a forfeiture of a portion or the entirety of the \$500 deposit.
14. A valid business license with a sellers permit shall be secured prior to commencement of the limited duration use.
15. All signs shall be in compliance with Chapter 20.42 (Sign Standards) of the Newport Beach Municipal Code and the site is limited to two (2) temporary banner signs not to exceed 75 square feet each.
16. Signage shall be placed in a manner such that they do not impact views of drivers entering and exiting the site.
17. All proposed temporary structures and any site contents shall be located within the private property lines.
18. The applicant shall provide a minimum of two (2) 2A-10BC fire extinguishers to be mounted in a visible, unobstructed location at a height of three to five feet. Additional fire extinguishers may be necessary to provide additional coverage in certain areas or where access to an extinguisher from any point exceeds a 75-foot travel distance.
19. All flocking material shall be flame retardant.
20. Combustible ground covering greater than two inches in depth shall not be permitted unless approved by the Fire Department. Straw and other combustible ground covering shall be maintained in a damp or moist condition and/or be treated with an approved fire-retardant chemical.

21. Open flames such as, but not limited to, torches, candles, warming devices and other devices using a flame capable of igniting combustible materials shall not be used in or adjacent to tents or canopies. Open flames shall also not be used near or on combustible decorations or materials such as, but not limited to weeds, straw, hay and the like unless previously approved by the Fire Department.
22. Smoking shall not be permitted in tents or canopies or in adjacent areas where hay, straw, sawdust, Christmas trees, or other combustible materials are being used, displayed, or stored. "NO-SMOKING" signs shall be conspicuously posted throughout the lot and in the tent or canopy as well as all points of entry in such a manner that they are visible to all patrons who enter the premises.
23. All weeds, combustible vegetation, trash and combustible storage shall be removed from areas adjacent to and within 30 feet of tents and canopies.
24. The applicant shall contact the Fire Department and obtain necessary permitting if a tent or canopy is proposed on the lot. All tents or canopies shall be consistent with Fire Department Guideline A.03 – Tents and Temporary Membrane Structures.
25. The approval of the requested limited term permit is contingent upon compliance with applicable provisions of the Municipal Code and the successful granting of all required permits from any other department or governing agency.
26. To the fullest extent permitted by law, applicant shall indemnify, defend and hold harmless City, its City Council, its boards and commissions, officials, officers, employees, and agents from and against any and all claims, demands, obligations, damages, actions, causes of action, suits, losses, judgments, fines, penalties, liabilities, costs and expenses (including without limitation, attorney's fees, disbursements and court costs) of every kind and nature whatsoever which may arise from or in any manner relate (directly or indirectly) to City's approval of the Trees by the Sea Christmas Tree Lot including, but not limited to, the XP2012-004 (PA2012-152). This indemnification shall include, but not be limited to, damages awarded against the City, if any, costs of suit, attorneys' fees, and other expenses incurred in connection with such claim, action, causes of action, suit or proceeding whether incurred by applicant, City, and/or the parties initiating or bringing such proceeding. The applicant shall indemnify the City for all of City's costs, attorneys' fees, and damages which City incurs in enforcing the indemnification provisions set forth in this condition. The applicant shall pay to the City upon demand any amount owed to the City pursuant to the indemnification requirements prescribed in this condition.

APPEAL PERIOD: Limited Term Permit applications do not become effective until 14 days following the date of action. Prior to the effective date the applicant or any interested party may appeal the decision of the Zoning Administrator to the Planning Commission by submitting a written appeal application to the Community Development Director. For additional information on filing an appeal, contact the Planning Division at 949-644-3200.

By: 
Brenda Wisneski, AICP, Zoning Administrator

JG/jvp

- Attachments: ZA 1 Vicinity Map
 ZA 2 Site Plan
 ZA 3 Other

Attachment No. ZA 1

Vicinity Map

VICINITY MAP



Limited Term Permit - Seasonal No. XP2012-004
PA2012-152

1520 W. Coast Highway

Attachment No. ZA 2

Site Plan

Attachment No. ZA 3

Other



Trees by the Sea: Seasonal Temporary Permit @ 1520 W Coast Highway

PA2012-152 for XP2012-004
1520 West Coast Highway
Trees by the Sea – Lauren Mitchell

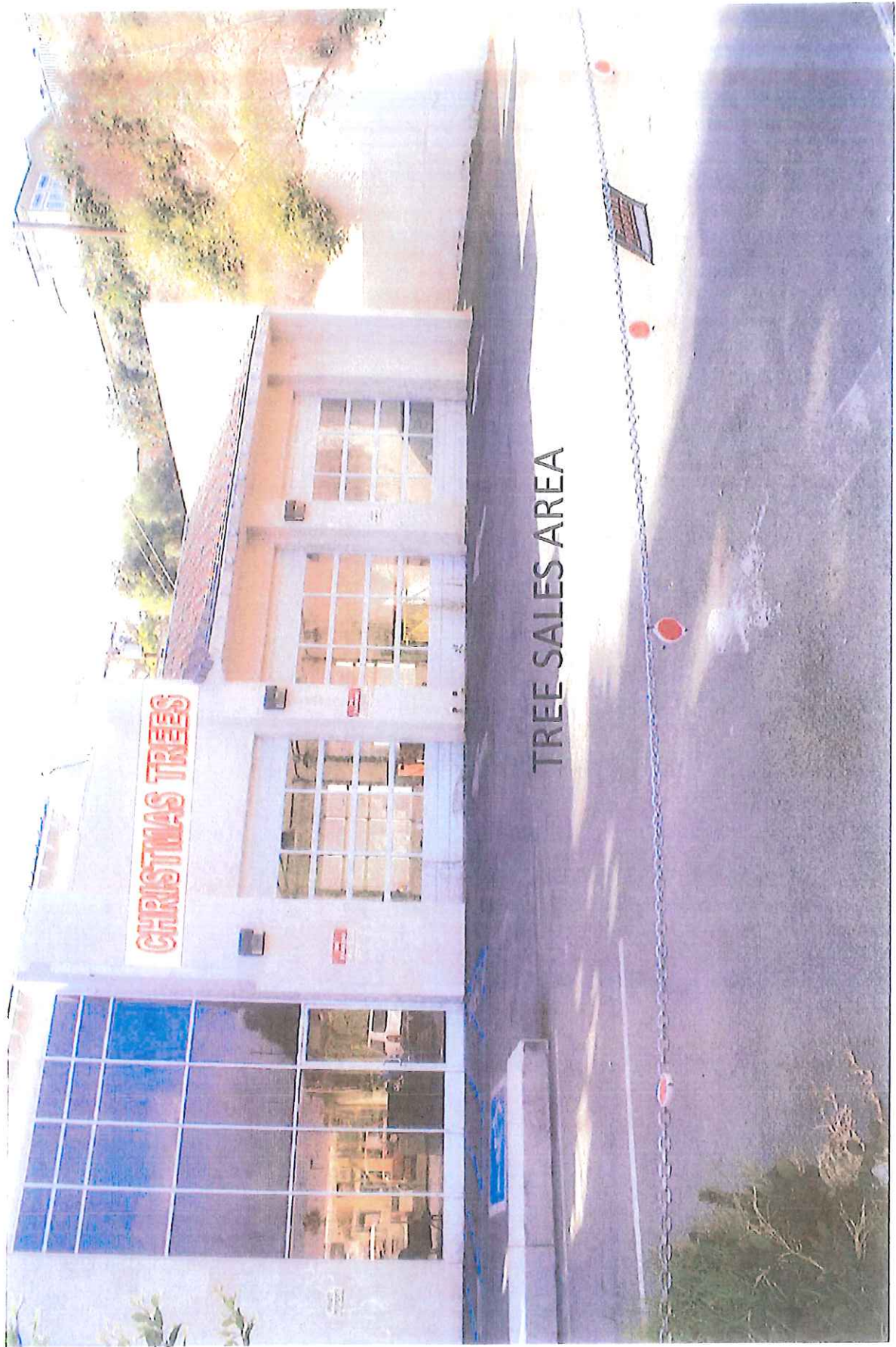

PA2012-152 for XP2012-004
1520 West Coast Highway
Trees by the Sea – Lauren Mitchell



PA2012-152 for XP2012-004
1520 West Coast Highway
Trees by the Sea – Lauren Mitchell



PA2012-152 for XP2012-004

1520 West Coast Highway

Trees by the Sea – Lauren Mitchell



COMMUNITY DEVELOPMENT DEPARTMENT
PLANNING DIVISION

3300 Newport Boulevard, Building C, Newport Beach, CA 92663
(949) 644-3200 Fax: (949) 644-3229

www.newportbeachca.gov

ZONING ADMINISTRATOR ACTION LETTER

Application No. Limited Term Permit – Seasonal No. XP2012-006
(PA2012-156)

Applicant Eric Hanna

Site Address 3928 E. Coast Highway
Gallo’s Christmas Tree Lot

Legal Description Tract No. 673, Block B, Lot 56, 57 & Lot 58 and a Portion of
the Abandoned Alley

On **November 19, 2012**, the Zoning Administrator approved the following: A Limited Term Permit application for a Christmas tree sales lot (Seasonal Sales) on a vacant lot. The property is located in the RM (Multi-Unit Residential) District. The Zoning Administrator’s approval is based on the following findings and subject to the following conditions.

FINDINGS

1. **Finding:** This project has been reviewed, and it has been determined that it is categorically exempt from the requirements of the California Environmental Quality Act under Class 4 (Sec. 15304 Minor Alterations to Land).

Facts in Support of Finding:

- Class 4 exempts minor temporary uses of land having negligible or no permanent effects on the environment, including carnivals, sales of Christmas trees, etc.
2. **Finding:** The operation of the requested limited duration use at the location proposed and within the time period specified would not be detrimental to the harmonious and orderly growth of the City, nor endanger, jeopardize, or otherwise constitute a hazard to the public convenience, health, interest, safety, or general welfare of persons residing or working in the neighborhood of the requested limited duration use;

Facts in Support of Finding:

- The operation of the temporary Christmas tree sales lot has been reviewed and conditioned to preclude any detriment and to uphold the general welfare of the area.
 - The lot has been used as a Christmas tree sales lot in the past and has not proven detrimental.
3. **Finding:** The subject lot is adequate in size and shape to accommodate the limited duration use without material detriment to the use and enjoyment of other properties located adjacent to and in the vicinity of the lot;

Facts in Support of Finding:

- The subject lot is approximately 11,700 square feet in area and is adequate in size to accommodate the proposed tree display area, storage container, sales booth, sawhorse area, and tree storage area.
 - All temporary structures and improvements will be erected on private property.
4. **Finding:** The subject lot is adequately served by streets or highways having sufficient width and improvements to accommodate the kind and quantity of traffic that the limited duration use would or could reasonably be expected to generate;

Facts in Support of Finding:

- Access and parking for the site will occur by way of the existing driveway and parking lot located at 3916 East Coast Hwy.
5. **Finding:** Adequate temporary parking to accommodate vehicular traffic to be generated by the limited duration use would be available either on-site or at alternate locations acceptable to the Zoning Administrator; and

Facts in Support of Finding:

- The Christmas tree sales lot is not anticipated to generate an excess of vehicular traffic.
- Adequate temporary parking will be provided by way of the ten (10) spaces located on subject lot and the seven (7) spaces located on the abutting parking lot at 3916 East Coast Hwy.
- The take-out service, limited use (Gallo's Italian Subs) located at 3900 East Coast Highway is adequately served by the three (3) spaces located onsite and will not be negatively impacted by the proposed limited duration use.

6. **Finding:** The limited duration use is consistent with all applicable provisions of the General Plan, any applicable specific plan, the Municipal Code, and other City regulations.

Facts in Support of Finding:

- The Christmas tree sales lot is conditioned such that it will comply with all applicable provisions of the General Plan, Municipal Code, and other City regulations.
- The subject lot is not located within any specific plan.

CONDITIONS

1. The limited duration use shall not commence operation prior to November 23, 2012 and shall conclude by December 26, 2012.
2. All temporary structures shall be anchored and a building permit shall be secured for those structures as required by the Building Division.
3. Inspection of all temporary structures is required by a Building Division Inspector. Permittee shall comply with all lawful orders and requirements of the Building Inspector. Inspection approval is required before the canopy can be entered by the public.
4. The limited duration use shall only operate between the hours of 9:00 a.m. and 9:00 p.m., daily.
5. The operator of the limited duration use shall be responsible for the control of noise generated by the subject facility including, but not limited to, noise generated by patrons and equipment. All noise generated by the proposed use shall comply with the provisions of Chapter 10.26 and other applicable noise control requirements of the Newport Beach Municipal Code. If noise generation does not comply with the aforementioned provisions, the Community Development Director may require remediation measures which may include relocation of equipment.
6. Lighting shall be in compliance with applicable standards of the Zoning Code. Exterior on-site lighting shall be shielded and confined within site boundaries. No direct rays or glare are permitted to shine onto public streets or adjacent sites or create a public nuisance. "Walpak" type fixtures are not permitted. If in the opinion of the Community Development Director, existing illumination creates an unacceptable negative impact on surrounding land uses or sensitive habitat areas he or she may order the dimming of light sources or other remediation upon finding that the site is excessively illuminated. An electrical permit shall be secured for lighting as required by the Building Division.

7. All electrical shall be in good working order and shall be protected from pedestrian traffic.
8. Accommodations for accessibility shall be provided.
9. One (1) parking space with 8 foot loading zone shall be marked and signed for the disabled for the limited duration of use, in compliance with the Americans with Disabilities Act (ADA), 2012 California Building Code, and subject to signage standards set forth by the Building Department.
10. The parking space closest to the trash enclosure shall be utilized as a designated turnaround area and shall be posted with a sign such that no parking is permitted.
11. The site driveway access shall have adequate sight distance pursuant to City Standard STD-110-L.
12. The applicant shall ensure patron vehicles do not impact traffic flow on East Coast Highway.
13. The site shall be cleaned of debris, litter, or any other evidence of the limited duration use upon completion or removal of the use, and shall continue to be used in compliance with this Zoning Code. The site shall be adequately cleaned and inspected by Code Enforcement by midnight on December 31, 2012. Failure to do so will result in a forfeiture of a portion or the entirety of the \$500 deposit.
14. A valid business license with a sellers permit shall be secured prior to commencement of the limited duration use.
15. All signs shall be in compliance with Chapter 20.42 (Sign Standards) of the Newport Beach Municipal Code and the site is limited to two (2) temporary banner signs not to exceed 75 square feet each.
16. Signage shall be placed in a manner such that they do not impact views of drivers entering and exiting the site.
17. All proposed temporary structures and any site contents shall be located within the private property lines.
18. The applicant shall provide a minimum of two (2) 2A-10BC fire extinguishers to be mounted in a visible, unobstructed location at a height of three to five feet. Additional fire extinguishers may be necessary to provide additional coverage in certain areas or where access to an extinguisher from any point exceeds a 75-foot travel distance.
19. All flocking material shall be flame retardant.

20. Combustible ground covering greater than two inches in depth shall not be permitted unless approved by the Fire Department. Straw and other combustible ground covering shall be maintained in a damp or moist condition and/or be treated with an approved fire-retardant chemical.
21. Open flames such as, but not limited to, torches, candles, warming devices and other devices using a flame capable of igniting combustible materials shall not be used in or adjacent to tents or canopies. Open flames shall also not be used near or on combustible decorations or materials such as, but not limited to weeds, straw, hay and the like unless previously approved by the Fire Department.
22. Smoking shall not be permitted in tents or canopies or in adjacent areas where hay, straw, sawdust, Christmas trees, or other combustible materials are being used, displayed, or stored. "NO-SMOKING" signs shall be conspicuously posted throughout the lot and in the tent or canopy as well as all points of entry in such a manner that they are visible to all patrons who enter the premises.
23. All weeds, combustible vegetation, trash and combustible storage shall be removed from areas adjacent to and within 30 feet of tents and canopies.
24. The applicant shall contact the Fire Department and obtain necessary permitting if a tent or canopy is proposed on the lot. All tents or canopies shall be consistent with Fire Department Guideline A.03 – Tents and Temporary Membrane Structures.
25. The approval of the requested limited term permit is contingent upon compliance with applicable provisions of the Municipal Code and the successful granting of all required permits from any other department or governing agency.
26. To the fullest extent permitted by law, applicant shall indemnify, defend and hold harmless City, its City Council, its boards and commissions, officials, officers, employees, and agents from and against any and all claims, demands, obligations, damages, actions, causes of action, suits, losses, judgments, fines, penalties, liabilities, costs and expenses (including without limitation, attorney's fees, disbursements and court costs) of every kind and nature whatsoever which may arise from or in any manner relate (directly or indirectly) to City's approval of the Gallo's Christmas Tree Lot including, but not limited to, the XP2012-006 (PA2012-156). This indemnification shall include, but not be limited to, damages awarded against the City, if any, costs of suit, attorneys' fees, and other expenses incurred in connection with such claim, action, causes of action, suit or proceeding whether incurred by applicant, City, and/or the parties initiating or bringing such proceeding. The applicant shall indemnify the City for all of City's costs, attorneys' fees, and damages which City incurs in enforcing the indemnification provisions set forth in this condition. The applicant shall pay to the City upon demand any amount owed to the City pursuant to the indemnification requirements prescribed in this condition.

APPEAL PERIOD: Limited Term Permit applications do not become effective until 14 days following the date of action. Prior to the effective date the applicant or any interested party may appeal the decision of the Zoning Administrator to the Planning Commission by submitting a written appeal application to the Community Development Director. For additional information on filing an appeal, contact the Planning Division at 949-644-3200.

By:



Brenda Wisneski, AICP, Zoning Administrator

JG/jyp

Attachments: ZA 1 Vicinity Map
 ZA 2 Site Plan
 ZA 3 Other

VICINITY MAP



Limited Term Permit – Seasonal No. XP2012-006
PA2012-156

3928 E. Coast Highway

Attachment No. ZA 2

Site Plan

Gallas Christmas Trees

PARKING LOT: GALLO'S

(POWER-PULLED FROM GALLO'S)

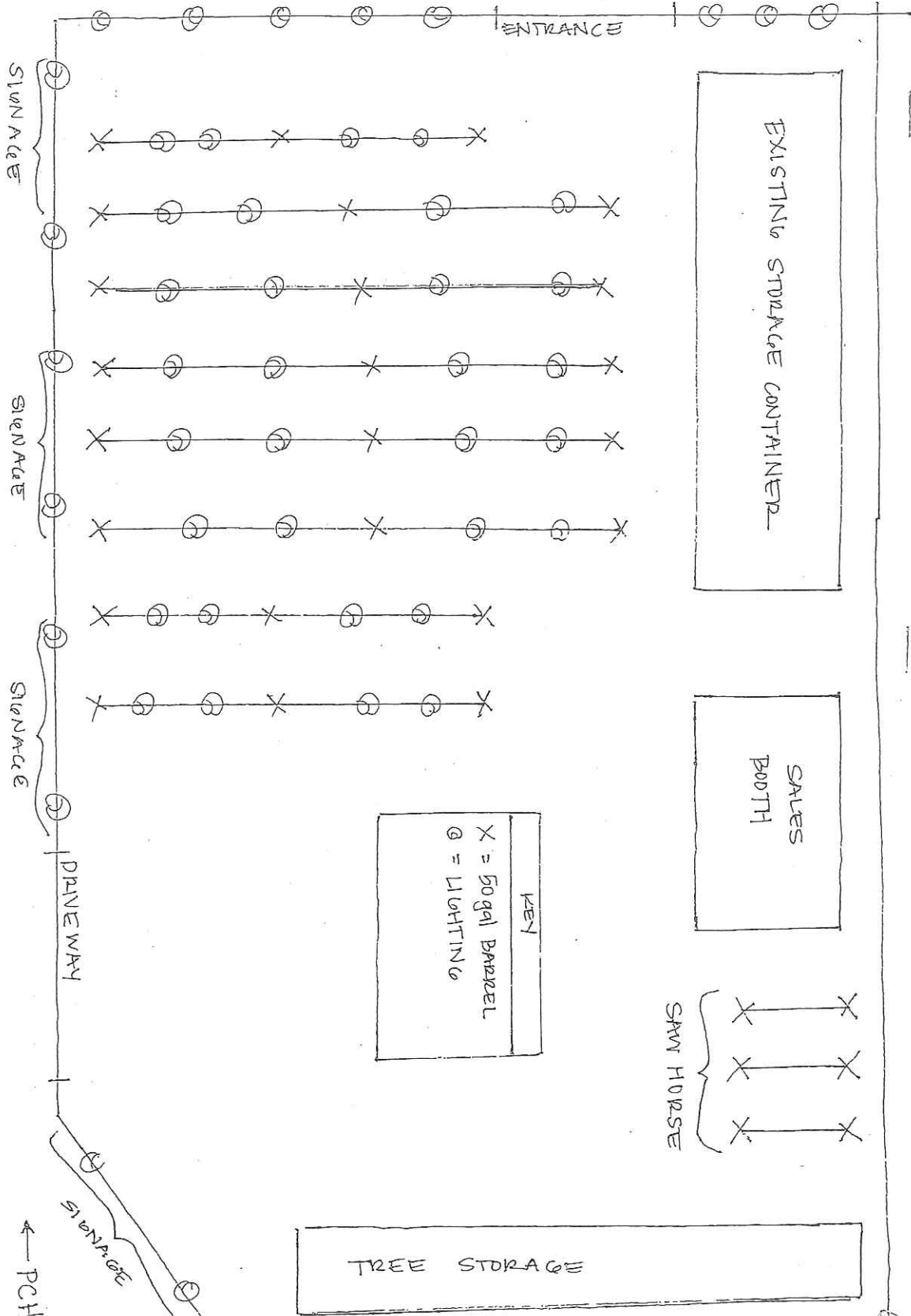

PA2012-156 for XP2012-006
 3928 East Coast Highway
 Camden De Veer - Eric Hanna

Attachment No. ZA 3

Other





PA2012-156 for XP2012-006
3928 East Coast Highway
Camden De Veer – Eric Hanna

Gallo's Italian
Deli/CDM



COMMUNITY DEVELOPMENT DEPARTMENT
PLANNING DIVISION

3300 Newport Boulevard, Building C, Newport Beach, CA 92663
(949) 644-3200 Fax: (949) 644-3229

www.newportbeachca.gov

ZONING ADMINISTRATOR ACTION LETTER

Application No. Limited Term Permit – Seasonal No. XP2012- 007
(PA2012-157)

Applicant Dawne Reed
Newport Dunes Resort and Marina

Site Address 1131 Back Bay Drive
Newport Dunes Resort and Marina Christmas Tree Lot

Legal Description Parcel Map Book 305, Page 30, Parcel B

On **November 19, 2012**, the Zoning Administrator approved the following: A Limited Term Permit application for a Christmas tree sales lot (Seasonal Sales) at an existing parking lot for the Newport Dunes Resort and Marina. The property is located in the PC-48 (Newport Dunes) District. The Zoning Administrator's approval is based on the following findings and subject to the following conditions.

FINDINGS

1. **Finding:** This project has been reviewed, and it has been determined that it is categorically exempt from the requirements of the California Environmental Quality Act under Class 4 (Sec. 15304 Minor Alterations to Land).

Facts in Support of Finding:

- Class 4 exempts minor temporary uses of land having negligible or no permanent effects on the environment, including carnivals, sales of Christmas trees, etc.
2. **Finding:** The operation of the requested limited duration use at the location proposed and within the time period specified would not be detrimental to the harmonious and orderly growth of the City, nor endanger, jeopardize, or otherwise constitute a hazard to the public convenience, health, interest, safety, or general welfare of persons residing or working in the neighborhood of the requested limited duration use;

Facts in Support of Finding:

- The operation of the temporary Christmas tree sales lot has been reviewed and conditioned to preclude any detriment and to uphold the general welfare of the area.
- The lot has been used as a Christmas tree sales lot in the past and has not proven detrimental.

3. **Finding:** The subject lot is adequate in size and shape to accommodate the limited duration use without material detriment to the use and enjoyment of other properties located adjacent to and in the vicinity of the lot;

Facts in Support of Finding:

- The proposed limited duration use will be located on a 4,800-square-foot portion of an existing parking lot that is approximately four acres in size and will be occupied by a tree display area, temporary office and sales booth, and a "Santa's Village" area.
- All temporary structures and improvements will be erected on private property.

4. **Finding:** The subject lot is adequately served by streets or highways having sufficient width and improvements to accommodate the kind and quantity of traffic that the limited duration use would or could reasonably be expected to generate;

Facts in Support of Finding:

- The subject lot has an arterial access street on private property that connects the parking lot area to Back Bay Drive.

5. **Finding:** Adequate temporary parking to accommodate vehicular traffic to be generated by the limited duration use would be available either on-site or at alternate locations acceptable to the Zoning Administrator; and

Facts in Support of Finding:

- The Christmas tree sales lot is not anticipated to generate an excess of vehicular traffic.
- Adequate temporary parking will be provided by way of the existing Newport Dunes Resort and Marina parking lot.
- The vehicular traffic anticipated will not impact the parking for patrons and guests of the Newport Dunes Resort and Marina.

6. **Finding:** The limited duration use is consistent with all applicable provisions of the General Plan, any applicable specific plan, the Municipal Code, and other City regulations.

Facts in Support of Finding:

- The Christmas tree sales lot is conditioned such that it will comply with all applicable provisions of the General Plan, Municipal Code, and other City regulations.
- The subject lot is not located within any specific plan.

CONDITIONS

1. The limited duration sales use shall not commence operation prior to November 23, 2012 and shall conclude by December 26, 2012.
2. All temporary structures shall be anchored and a building permit shall be secured for those structures as required by the Building Division.
3. Inspection of all temporary structures is required by a Building Division Inspector. Permittee shall comply with all lawful orders and requirements of the Building Inspector. Inspection approval is required before the canopy can be entered by the public.
4. The limited duration use shall only operate between the hours of 9:00 a.m. and 9:00 p.m., daily.
5. The operator of the limited duration use shall be responsible for the control of noise generated by the subject facility including, but not limited to, noise generated by patrons and equipment. All noise generated by the proposed use shall comply with the provisions of Chapter 10.26 and other applicable noise control requirements of the Newport Beach Municipal Code. If noise generation does not comply with the aforementioned provisions, the Community Development Director may require remediation measures which may include relocation of equipment.
6. Lighting shall be in compliance with applicable standards of the Zoning Code. Exterior on-site lighting shall be shielded and confined within site boundaries. No direct rays or glare are permitted to shine onto public streets or adjacent sites or create a public nuisance. "Walpak" type fixtures are not permitted. If in the opinion of the Community Development Director, existing illumination creates an unacceptable negative impact on surrounding land uses or sensitive habitat areas he or she may order the dimming of light sources or other remediation upon finding that the site is excessively illuminated. An electrical permit shall be secured for lighting as required by the Building Division.

7. All electrical shall be in good working order and shall be protected from pedestrian traffic.
8. Accommodations for accessibility shall be provided.
9. One (1) parking space with 8 foot loading zone shall be marked and signed for the disabled, in compliance with the Americans with Disabilities Act (ADA) and 2012 California Building Code.
10. The site driveway access shall have adequate sight distance pursuant to City Standard STD-110-L.
11. The applicant shall ensure patron vehicles do not impact traffic flow on Back Bay Drive.
12. Operation of the Christmas tree lot/sales shall not impact the vehicular circulation through the remaining parking areas.
13. The site shall be cleaned of debris, litter, or any other evidence of the limited duration use upon completion or removal of the use, and shall continue to be used in compliance with this Zoning Code. The site shall be adequately cleaned and inspected by Code Enforcement by midnight on December 31, 2012. Failure to do so will result in a forfeiture of a portion or the entirety of the \$500 deposit.
14. A valid business license with a sellers permit shall be secured prior to commencement of the limited duration use.
15. All signs shall be in compliance with Chapter 20.42 (Sign Standards) of the Newport Beach Municipal Code and the site is limited to two (2) temporary banner signs not to exceed 75 square feet each. Placement of temporary signage shall be subject to Planning Division approval.
16. Signage shall be placed in a manner such that they do not impact views of drivers entering and exiting the site.
17. All proposed temporary structures and any site contents shall be located within the private property lines.
18. The applicant shall provide a minimum of two (2) 2A-10BC fire extinguishers to be mounted in a visible, unobstructed location at a height of three to five feet. Additional fire extinguishers may be necessary to provide additional coverage in certain areas or where access to an extinguisher from any point exceeds a 75-foot travel distance.
19. All flocking material shall be flame retardant.

20. Combustible ground covering greater than two inches in depth shall not be permitted unless approved by the Fire Department. Straw and other combustible ground covering shall be maintained in a damp or moist condition and/or be treated with an approved fire-retardant chemical.
21. Open flames such as, but not limited to, torches, candles, warming devices and other devices using a flame capable of igniting combustible materials shall not be used in or adjacent to tents or canopies. Open flames shall also not be used near or on combustible decorations or materials such as, but not limited to weeds, straw, hay and the like unless previously approved by the Fire Department.
22. Smoking shall not be permitted in tents or canopies or in adjacent areas where hay, straw, sawdust, Christmas trees, or other combustible materials are being used, displayed, or stored. "NO-SMOKING" signs shall be conspicuously posted throughout the lot and in the tent or canopy as well as all points of entry in such a manner that they are visible to all patrons who enter the premises.
23. All weeds, combustible vegetation, trash and combustible storage shall be removed from areas adjacent to and within 30 feet of tents and canopies.
24. The applicant shall contact the Fire Department and obtain necessary permitting if a tent or canopy is proposed on the lot. All tents or canopies shall be consistent with Fire Department Guideline A.03 – Tents and Temporary Membrane Structures.
25. The approval of the requested limited term permit is contingent upon compliance with applicable provisions of the Municipal Code and the successful granting of all required permits from any other department or governing agency.
26. To the fullest extent permitted by law, applicant shall indemnify, defend and hold harmless City, its City Council, its boards and commissions, officials, officers, employees, and agents from and against any and all claims, demands, obligations, damages, actions, causes of action, suits, losses, judgments, fines, penalties, liabilities, costs and expenses (including without limitation, attorney's fees, disbursements and court costs) of every kind and nature whatsoever which may arise from or in any manner relate (directly or indirectly) to City's approval of the Newport Dunes Resort and Marina Christmas Tree Lot including, but not limited to, the XP2012-007 (PA2012-157). This indemnification shall include, but not be limited to, damages awarded against the City, if any, costs of suit, attorneys' fees, and other expenses incurred in connection with such claim, action, causes of action, suit or proceeding whether incurred by applicant, City, and/or the parties initiating or bringing such proceeding. The applicant shall indemnify the City for all of City's costs, attorneys' fees, and damages which City incurs in enforcing the indemnification provisions set forth in this condition. The applicant shall pay to the City upon demand any amount owed to the City pursuant to the indemnification requirements prescribed in this condition.

APPEAL PERIOD: Limited Term Permit applications do not become effective until 14 days following the date of action. Prior to the effective date the applicant or any interested party may appeal the decision of the Zoning Administrator to the Planning Commission by submitting a written appeal application to the Community Development Director. For additional information on filing an appeal, contact the Planning Division at 949-644-3200.

By:



Brenda Wisneski, AICP, Zoning Administrator

JG/jvp

Attachments: ZA 1 Vicinity Map
 ZA 2 Site Plan

VICINITY MAP



Limited Term Permit – Seasonal No. XP2012-157
PA2012-007

1131 Back Bay Drive

Attachment No. ZA 2
Site Plan

FREE TENT - NEWPORT DUNES RESORT 2010

1201 BACK BAY DRIVE
NEWPORT BEACH, CA 92660
80' X 60'
949-880-3101

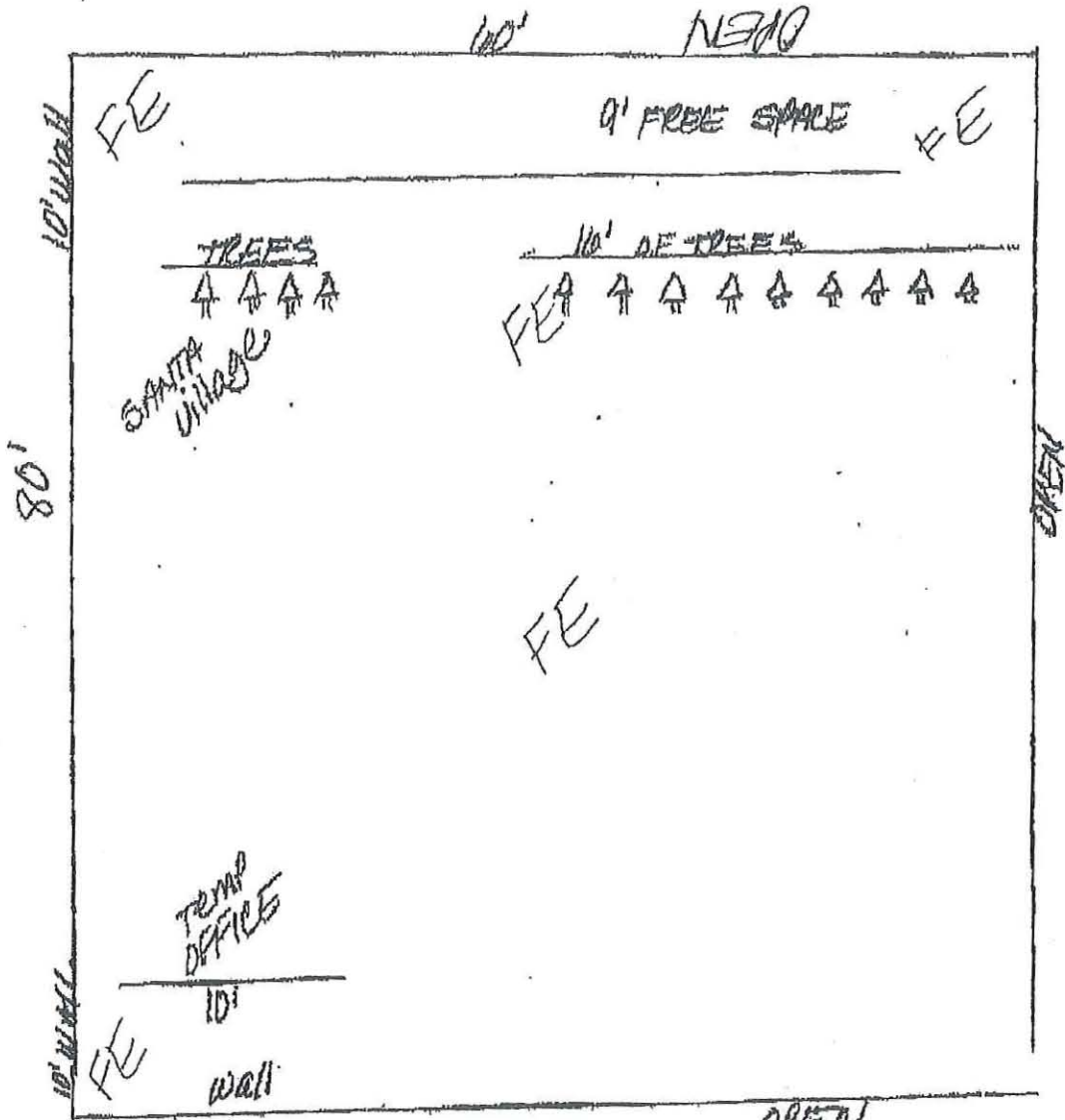

Is this all open
or is there a wall?

FE = FIRE EXTINGUISHERS